

D Schneidringverschraubungen DIN 2353 / EN ISO 8434-1

Compression fittings DIN 2353 / EN ISO 8434-1

Gerade, Winkel, T- und K-Verschraubungen

Straight, elbow, tee- and cross-couplings

Gerade Verschraubung, leichte + schwere Reihe

straight coupling, light + heavy duty series

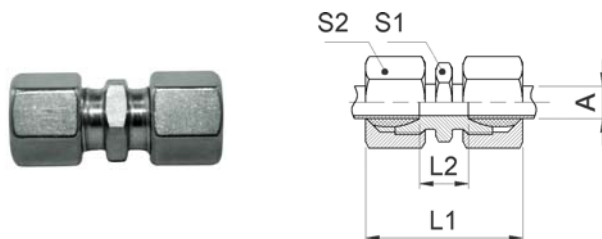

Reihe series	A / Rohr pipe	PN bar	L1 (mm)	L2 (mm)	S1 (mm)	S2 (mm)	Art. Nr. order no.
L	6	250	39,0	10,0	12,0	14,0	G06L
L	8	250	40,0	11,0	14,0	17,0	G08L
L	10	250	42,0	13,0	17,0	19,0	G10L
L	12	250	43,0	14,0	19,0	22,0	G12L
L	15	250	46,0	16,0	24,0	27,0	G15L
L	18	160	48,0	16,0	27,0	32,0	G18L
L	22	160	52,0	20,0	32,0	36,0	G22L
L	28	100	54,0	21,0	41,0	41,0	G28L
L	35	100	63,0	20,0	46,0	50,0	G35L
L	42	100	66,0	21,0	55,0	60,0	G42L

Reihe series	A / Rohr pipe	PN bar	L1 (mm)	L2 (mm)	S1 (mm)	S2 (mm)	Art. Nr. order no.
S	6	630	45,0	16,0	14,0	17,0	G06S
S	8	630	47,0	18,0	17,0	19,0	G08S
S	10	630	49,0	17,0	19,0	22,0	G10S
S	12	630	51,0	19,0	22,0	24,0	G12S
S	14	630	57,0	22,0	24,0	27,0	G14S
S	16	400	57,0	21,0	27,0	30,0	G16S
S	20	400	66,0	23,0	32,0	36,0	G20S
S	25	400	74,0	26,0	41,0	46,0	G25S
S	30	250	80,0	27,0	46,0	50,0	G30S
S	38	250	90,0	29,0	55,0	60,0	G38S

Winkel-Verschraubung, leichte + schwere Reihe
elbow coupling, light + heavy duty series

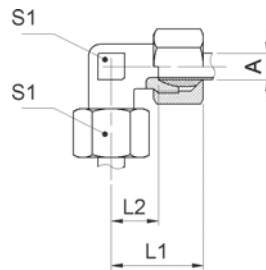

Reihe series	A / Rohr pipe	PN bar	L1 (mm)	L2 (mm)	S1 (mm)	S2 (mm)	Art. Nr. order no.
L	6	250	27,0	12,0	12,0	14,0	W06L
L	8	250	29,0	14,0	14,0	17,0	W08L
L	10	250	30,0	15,0	17,0	19,0	W10L
L	12	250	32,0	17,0	19,0	22,0	W12L
L	15	250	36,0	21,0	19,0	27,0	W15L
L	18	160	40,0	23,5	24,0	32,0	W18L
L	22	160	44,0	27,5	27,0	36,0	W22L
L	28	100	47,0	30,5	36,0	41,0	W28L
L	35	100	56,0	34,5	41,0	50,0	W35L
L	42	100	63,0	40,0	50,0	60,0	W42L

Reihe series	A / Rohr pipe	PN bar	L1 (mm)	L2 (mm)	S1 (mm)	S2 (mm)	Art. Nr. order no.
S	6	630	31,0	16,0	14,0	17,0	W06S
S	8	630	32,0	17,0	17,0	19,0	W08S
S	10	630	34,0	17,5	19,0	22,0	W10S
S	12	630	38,0	21,5	22,0	24,0	W12S
S	14	630	40,0	22,0	19,0	27,0	W14S
S	16	400	43,0	24,5	24,0	30,0	W16S
S	20	400	48,0	26,5	27,0	36,0	W20S
S	25	400	54,0	30,0	36,0	46,0	W25S
S	30	250	62,0	35,5	41,0	50,0	W30S
S	38	250	72,0	41,0	50,0	60,0	W38S

T-Verschraubung, leichte + schwere Reihe
T-coupling, light + heavy duty series

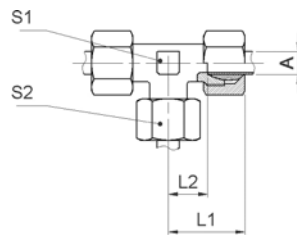

Reihe series	A / Rohr pipe	PN bar	L1 (mm)	L2 (mm)	S1 (mm)	S2 (mm)	Art. Nr. order no.
L	6	250	27,0	12,0	12,0	14,0	T06L
L	8	250	29,0	14,0	14,0	17,0	T08L
L	10	250	30,0	15,0	14,0	19,0	T10L
L	12	250	32,0	17,0	17,0	22,0	T12L
L	15	250	36,0	21,0	19,0	27,0	T15L
L	18	160	40,0	23,5	24,0	32,0	T18L
L	22	160	44,0	27,5	27,0	36,0	T22L
L	28	100	47,0	30,5	36,0	41,0	T28L
L	35	100	56,0	34,5	41,0	50,0	T35L
L	42	100	63,0	40,0	50,0	60,0	T42L

Reihe series	A / Rohr pipe	PN bar	L1 (mm)	L2 (mm)	S1 (mm)	S2 (mm)	Art. Nr. order no.
S	6	630	31,0	16,0	14,0	17,0	T06S
S	8	630	32,0	17,0	14,0	19,0	T08S
S	10	630	34,0	17,5	17,0	22,0	T10S
S	12	630	38,0	21,5	17,0	24,0	T12S
S	14	630	40,0	22,0	19,0	27,0	T14S
S	16	400	43,0	24,5	24,0	30,0	T16S
S	20	400	48,0	26,5	27,0	36,0	T20S
S	25	400	54,0	30,0	36,0	46,0	T25S
S	30	250	62,0	35,5	41,0	50,0	T30S
S	38	250	72,0	41,0	50,0	60,0	T38S

Kreuz-Verschraubung, leichte + schwere Reihe
cross coupling, light + heavy duty series

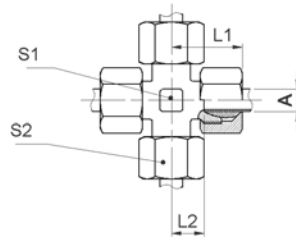

Reihe series	A / Rohr pipe	PN bar	L1 (mm)	L2 (mm)	S1 (mm)	S2 (mm)	Art. Nr. order no.
L	6	250	27,0	12,0	12,0	14,0	K06L
L	8	250	29,0	14,0	12,0	17,0	K08L
L	10	250	30,0	15,0	14,0	19,0	K10L
L	12	250	32,0	17,0	17,0	22,0	K12L
L	15	250	36,0	21,0	19,0	27,0	K15L
L	18	160	40,0	23,5	24,0	32,0	K18L
L	22	160	44,0	27,5	27,0	36,0	K22L
L	28	100	47,0	30,5	36,0	41,0	K28L
L	35	100	56,0	34,5	41,0	50,0	K35L
L	42	100	63,0	40,0	50,0	60,0	K42L

Reihe series	A / Rohr pipe	PN bar	L1 (mm)	L2 (mm)	S1 (mm)	S2 (mm)	Art. Nr. order no.
S	6	630	31,0	16,0	12,0	17,0	K06S
S	8	630	32,0	17,0	14,0	19,0	K08S
S	10	630	34,0	17,5	17,0	22,0	K10S
S	12	630	38,0	21,5	17,0	24,0	K12S
S	14	630	40,0	22,0	19,0	27,0	K14S
S	16	400	43,0	24,5	24,0	30,0	K16S
S	20	400	48,0	26,5	27,0	36,0	K20S
S	25	400	54,0	30,0	36,0	46,0	K25S
S	30	250	62,0	35,5	41,0	50,0	K30S
S	38	250	72,0	41,0	50,0	60,0	K38S

Gerade Einschraubverschraubungen Straight male stud couplings

Gerade Einschraubverschraubung;
Einschraubgewinde BSPP mit Dichtkante Form B, leichte Reihe
straight male stud coupling; male thread
BSPP with sealing edge form B, light duty series

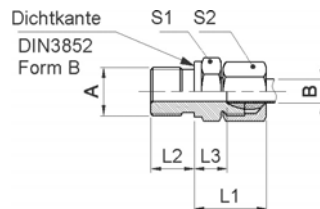

Reihe series	A / Gewinde thread	B / Rohr pipe	PN bar	L1 (mm)	L2 (mm)	L3 (mm)	S1 (mm)	S2 (mm)	Art. Nr. order no.
L	G 1/8"	6	250	23,0	8,0	8,5	14,0	14,0	GE06L01
L	G 1/4"	6	250	25,0	12,0	10,0	19,0	14,0	GE06L02
L	G 3/8"	6	250	26,0	12,0	11,5	22,0	14,0	GE06L03
L	G 1/2"	6	250	27,0	14,0	12,0	27,0	14,0	GE06L04
L	G 1/8"	8	250	23,0	8,0	8,5	14,0	17,0	GE08L01
L	G 1/4"	8	250	25,0	12,0	10,0	19,0	17,0	GE08L02
L	G 3/8"	8	250	26,0	12,0	11,5	22,0	17,0	GE08L03
L	G 1/2"	8	250	27,0	14,0	12,0	27,0	17,0	GE08L04
L	G 1/8"	10	250	25,0	8,0	10,5	17,0	19,0	GE10L01
L	G 1/4"	10	250	26,0	12,0	11,0	19,0	19,0	GE10L02
L	G 3/8"	10	250	27,0	12,0	12,5	22,0	19,0	GE10L03
L	G 1/2"	10	250	28,0	14,0	13,0	27,0	19,0	GE10L04
L	G 3/4"	10	250	30,0	16,0	15,0	32,0	19,0	GE10L06
L	G 1/8"	12	250	26,0	8,0	11,5	19,0	22,0	GE12L01
L	G 1/4"	12	250	27,0	12,0	12,0	19,0	22,0	GE12L02
L	G 3/8"	12	250	27,0	12,0	12,5	22,0	22,0	GE12L03
L	G 1/2"	12	250	28,0	14,0	13,0	27,0	22,0	GE12L04
L	G 3/4"	12	250	29,0	16,0	14,0	32,0	22,0	GE12L06
L	G 1/4"	15	250	28,0	12,0	14,0	24,0	27,0	GE15L02
L	G 3/8"	15	250	29,0	12,0	13,5	24,0	27,0	GE15L03
L	G 1/2"	15	250	29,0	14,0	14,0	27,0	27,0	GE15L04
L	G 3/4"	15	250	30,0	16,0	15,0	32,0	27,0	GE15L06
L	G 1"	15	250	31,0	18,0	16,5	41,0	27,0	GE15L08
L	G 3/8"	18	160	29,5	12,0	14,0	27,0	32,0	GE18L03
L	G 1/2"	18	160	31,0	14,0	14,5	27,0	32,0	GE18L04
L	G 3/4"	18	160	31,0	16,0	14,5	32,0	32,0	GE18L06
L	G 1"	18	160	33,0	18,0	18,0	41,0	32,0	GE18L08
L	G 3/8"	22	160	32,0	12,0	16,5	32,0	36,0	GE22L03
L	G 1/2"	22	160	33,0	14,0	16,5	32,0	36,0	GE22L04
L	G 3/4"	22	160	33,0	16,0	16,5	32,0	36,0	GE22L06
L	G 1"	22	160	33,5	18,0	17,5	41,0	36,0	GE22L08
L	G 1 1/4"	22	160	35,0	20,0	19,0	50,0	36,0	GE22L10
L	G 1/2"	28	100	34,0	14,0	17,5	41,0	41,0	GE28L04
L	G 3/4"	28	100	34,0	16,0	17,5	41,0	41,0	GE28L06
L	G 1"	28	100	34,0	18,0	17,5	41,0	41,0	GE28L08
L	G 1 1/4"	28	100	35,0	20,0	18,3	50,0	41,0	GE28L10

**Gerade Einschraubverschraubung;
Einschraubgewinde BSPP mit Dichtkante Form B, leichte + schwere Reihe**
straight male stud coupling;
male thread BSPP with sealing edge form B, light + heavy duty series



Reihe series	A / Gewinde thread	B / Rohr pipe	PN bar	L1 (mm)	L2 (mm)	L3 (mm)	S1 (mm)	S2 (mm)	Art. Nr. order no.
L	G 3/4"	35	100	39,0	16,0	17,5	46,0	50,0	GE35L06
L	G 1"	35	100	39,0	18,0	17,5	46,0	50,0	GE35L08
L	G 1 1/4"	35	100	39,0	20,0	17,5	50,0	50,0	GE35L10
L	G 1 1/2"	35	100	41,0	22,0	19,5	55,0	50,0	GE35L12
L	G 1"	42	100	42,0	18,0	19,0	55,0	60,0	GE42L08
L	G 1 1/4"	42	100	42,0	20,0	19,0	55,0	60,0	GE42L10
L	G 1 1/2"	42	100	42,0	22,0	19,0	55,0	60,0	GE42L12

Reihe series	A / Gewinde thread	B / Rohr pipe	PN bar	L1 (mm)	L2 (mm)	L3 (mm)	S1 (mm)	S2 (mm)	Art. Nr. order no.
S	G 1/8"	6	630	27,0	8,0	12,5	14,0	17,0	GE06S01
S	G 1/4"	6	630	28,0	12,0	13,0	19,0	17,0	GE06S02
S	G 3/8"	6	630	30,0	12,0	15,5	22,0	17,0	GE06S03
S	G 1/2"	6	630	33,0	14,0	18,0	27,0	17,0	GE06S04
S	G 1/8"	8	630	28,0	8,0	13,0	17,0	19,0	GE08S01
S	G 1/4"	8	630	30,0	12,0	15,0	19,0	19,0	GE08S02
S	G 3/8"	8	630	31,0	12,0	15,5	22,0	19,0	GE08S03
S	G 1/2"	8	630	33,0	14,0	18,0	27,0	19,0	GE08S04
S	G 1/8"	10	630	29,5	8,0	14,5	22,0	22,0	GE10S01
S	G 1/4"	10	630	31,0	12,0	14,5	19,0	22,0	GE10S02
S	G 3/8"	10	630	31,0	12,0	15,0	22,0	22,0	GE10S03
S	G 1/2"	10	630	34,0	14,0	17,5	27,0	22,0	GE10S04
S	G 3/4"	10	630	36,0	16,0	18,5	32,0	22,0	GE10S06
S	G 1/8"	12	630	31,0	8,0	13,5	22,0	24,0	GE12S01
S	G 1/4"	12	630	33,0	12,0	16,5	22,0	24,0	GE12S02
S	G 3/8"	12	630	33,0	12,0	17,0	22,0	24,0	GE12S03
S	G 1/2"	12	630	34,0	14,0	17,5	27,0	24,0	GE12S04
S	G 3/4"	12	630	36,0	16,0	21,0	32,0	24,0	GE12S06
S	G 3/8"	14	630	36,0	12,0	18,5	24,0	27,0	GE14S03
S	G 1/2"	14	630	37,0	14,0	19,0	27,0	27,0	GE14S04
S	G 3/4"	14	630	38,0	16,0	19,0	32,0	27,0	GE14S06
S	G 1/4"	16	400	36,0	12,0	18,0	27,0	30,0	GE16S02
S	G 3/8"	16	400	36,0	12,0	18,0	27,0	30,0	GE16S03
S	G 1/2"	16	400	37,0	14,0	18,5	27,0	30,0	GE16S04
S	G 3/4"	16	400	39,0	16,0	20,5	32,0	30,0	GE16S06
S	G 1"	16	400	41,0	18,0	21,5	41,0	30,0	GE16S08
S	G 3/8"	20	400	42,0	12,0	19,0	32,0	36,0	GE20S03

Gerade Einschraubverschraubung;
Einschraubgewinde BSPP mit Dichtkante Form B, schwere Reihe
straight male stud coupling;
male thread BSPP with sealing edge form B, heavy duty series



Reihe series	A / Gewinde thread	B / Rohr pipe	PN bar	L1 (mm)	L2 (mm)	L3 (mm)	S1 (mm)	S2 (mm)	Art. Nr. order no.
S	G 1/2"	20	400	42,0	14,0	20,5	32,0	36,0	GE20S04
S	G 3/4"	20	400	42,0	16,0	20,5	32,0	36,0	GE20S06
S	G 1"	20	400	44,0	18,0	22,5	41,0	36,0	GE20S08
S	G 3/4"	20	400	42,0	16,0	20,5	32,0	36,0	GE20S06
S	G 1"	20	400	44,0	18,0	22,5	41,0	36,0	GE20S08
S	G 1 1/4"	20	400	44,0	20,0	22,5	50,0	36,0	GE20S10
S	G 1/2"	25	400	45,0	14,0	22,0	36,0	46,0	GE25S04
S	G 3/4"	25	400	47,0	16,0	23,0	41,0	46,0	GE25S06
S	G 1"	25	400	47,0	18,0	23,0	41,0	46,0	GE25S08
S	G 1 1/4"	25	400	47,0	20,0	23,0	50,0	46,0	GE25S10
S	G 3/4"	30	250	50,0	16,0	24,0	46,0	50,0	GE30S06
S	G 1"	30	250	50,0	18,0	23,5	46,0	50,0	GE30S08
S	G 1 1/4"	30	250	50,0	20,0	23,5	50,0	50,0	GE30S10
S	G 1 1/2"	30	250	53,0	22,0	23,5	55,0	50,0	GE30S12
S	G1"	38	250	54,0	18,0	23,0	55,0	60,0	GE38S08
S	G 1 1/4"	38	250	57,0	20,0	26,0	55,0	60,0	GE38S10
S	G 1 1/2"	38	250	57,0	22,0	26,0	55,0	60,0	GE38S12

Gerade Einschraubverschraubung,
Einschraubgewinde BSPT, leichte Reihe
straight male stud coupling,
male thread BSPT, light duty series

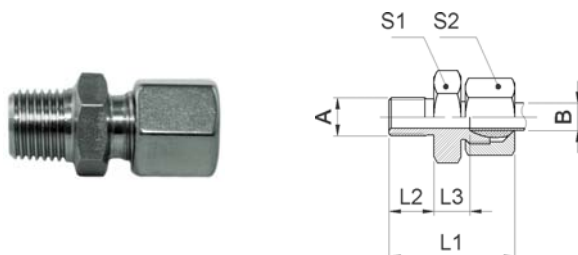

Reihe series	A / Gewinde thread	B / Rohr pipe	PN bar	L1 (mm)	L2 (mm)	L3 (mm)	S1 (mm)	S2 (mm)	Art. Nr. order no.
L	R 1/8" keg	6	250	30,0	8,0	7,5	12,0	14,0	GE06LK01
L	R 1/4" keg	6	250	35,0	12,0	8,5	17,0	14,0	GE06LK02

**Gerade Einschraubverschraubung,
Einschraubgewinde BSPT, leichte Reihe**
straight male stud coupling,
male thread BSPT, light duty series

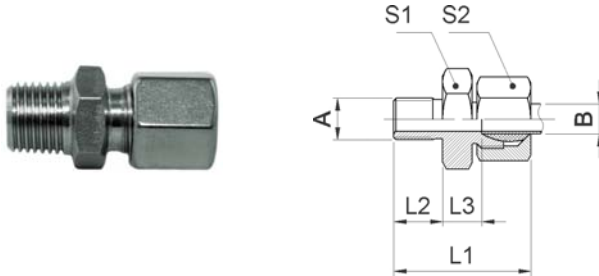

Reihe series	A / Gewinde thread	B / Rohr pipe	PN bar	L1 (mm)	L2 (mm)	L3 (mm)	S1 (mm)	S2 (mm)	Art. Nr. order no.
L	R 3/8" keg	6	250	38,0	12,0	11,5	19,0	14,0	GE06LK03
L	R 1/2" keg	6	250	38,0	14,0	9,5	22,0	14,0	GE06LK04
L	R 1/8" keg	8	250	31,0	8,0	10,0	17,0	17,0	GE08LK01
L	R 1/4" keg	8	250	35,0	12,0	8,0	17,0	17,0	GE08LK02
L	R 3/8" keg	8	250	37,0	13,0	9,0	19,0	17,0	GE08LK03
L	R 1/2" keg	8	250	37,0	14,0	8,0	22,0	17,0	GE08LK04
L	R 1/8" keg	10	250	31,0	8,0	8,0	19,0	19,0	GE10LK01
L	R 1/4" keg	10	250	36,0	12,0	9,0	17,0	19,0	GE10LK02
L	R 3/8" keg	10	250	36,0	12,0	9,0	19,0	19,0	GE10LK03
L	R 1/2" keg	10	250	38,0	14,0	9,0	22,0	19,0	GE10LK04
L	R 3/4" keg	10	250	42,0	16,0	11,0	24,0	19,0	GE10LK06
L	R 1/8" keg	12	250	31,0	8,0	10,0	19,0	22,0	GE12LK01
L	R 1/4" keg	12	250	37,0	12,0	10,0	19,0	22,0	GE12LK02
L	R 3/8" keg	12	250	37,0	12,0	10,0	19,0	22,0	GE12LK03
L	R 1/2" keg	12	250	39,0	14,0	10,0	24,0	22,0	GE12LK04
L	R 3/4" keg	12	250	42,0	16,0	11,0	30,0	22,0	GE12LK06
L	R 1/4" keg	15	250	38,0	12,0	11,0	24,0	27,0	GE15LK02
L	R 3/8" keg	15	250	38,0	12,0	11,0	24,0	27,0	GE15LK03
L	R 1/2" keg	15	250	40,0	14,0	11,0	24,0	27,0	GE15LK04
L	R 3/4" keg	15	250	42,0	16,0	11,0	27,0	27,0	GE15LK06
L	R 1" keg	15	250	43,0	18,0	12,0	36,0	27,0	GE15LK08
L	R 3/8" keg	18	160	39,0	12,0	10,5	27,0	27,0	GE18LK03
L	R 1/2" keg	18	160	42,0	14,0	11,5	27,0	32,0	GE18LK04
L	R 3/4" keg	18	160	43,0	16,0	10,5	27,0	32,0	GE18LK06
L	R 1" keg	18	160	43,0	18,0	12,0	36,0	32,0	GE18LK08
L	R 3/8" keg	22	160	42,0	12,0	13,5	32,0	36,0	GE22LK03
L	R 1/2" keg	22	160	44,0	14,0	13,5	32,0	36,0	GE22LK04
L	R 3/4" keg	22	160	46,0	16,0	13,5	32,0	36,0	GE22LK06
L	R 1" keg	22	160	48,0	18,0	13,5	36,0	36,0	GE22LK08
L	R 1 1/4" keg	22	160	49,0	20,0	12,5	41,0	41,0	GE22LK10
L	R 1/2" keg	28	100	48,0	14,0	17,5	41,0	41,0	GE28LK04
L	R 3/4" keg	28	100	50,0	16,0	17,5	41,0	41,0	GE28LK06
L	R 1" keg	28	100	49,0	18,0	14,5	41,0	41,0	GE28LK08
L	R 1 1/4" keg	28	100	50,0	20,0	13,5	41,0	41,0	GE28LK10
L	R 3/4" keg	35	100	50,0	16,0	12,5	46,0	50,0	GE35LK06
L	R 1" keg	35	100	52,0	18,0	12,5	46,0	50,0	GE35LK08
L	R 1 1/4" keg	35	100	56,0	20,0	14,5	46,0	50,0	GE35LK10
L	R 1 1/2" keg	35	100	56,0	22,0	12,5	55,0	50,0	GE35LK12
L	R 1 1/4" keg	42	100	59,0	20,0	16,0	55,0	60,0	GE42LK10

**Gerade Einschraubverschraubung,
Einschraubgewinde BSPT, schwere Reihe**
straight male stud coupling,
male thread BSPT, heavy duty series

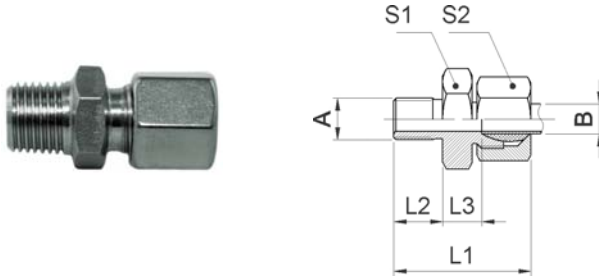

Reihe series	A / Gewinde thread	B / Rohr pipe	PN bar	L1 (mm)	L2 (mm)	L3 (mm)	S1 (mm)	S2 (mm)	Art. Nr. order no.
S	R 1/8" keg	6	630	36,0	9,0	12,0	17,0	17,0	GE06SK01
S	R 1/4" keg	6	630	38,0	12,0	11,0	17,0	17,0	GE06SK02
S	R 3/8" keg	6	630	40,0	12,0	13,0	17,0	17,0	GE06SK03
S	R 1/2" keg	6	630	44,0	14,0	15,0	22,0	17,0	GE06SK04
S	R 1/4" keg	8	630	38,0	12,0	11,0	17,0	19,0	GE08SK02
S	R 3/8" keg	8	630	40,0	12,0	13,0	17,0	19,0	GE08SK03
S	R 1/2" keg	8	630	44,0	14,0	15,0	22,0	19,0	GE08SK04
S	R 1/4" keg	10	630	41,0	12,0	13,0	22,0	22,0	GE10SK02
S	R 3/8" keg	10	630	39,0	13,0	10,0	19,0	22,0	GE10SK03
S	R 1/2" keg	10	630	43,0	14,0	13,0	24,0	22,0	GE10SK04
S	R 3/8" keg	12	630	42,0	12,0	14,0	22,0	24,0	GE12SK03
S	R 1/2" keg	12	630	44,0	14,0	14,0	24,0	24,0	GE12SK04
S	R 3/8" keg	14	630	45,0	12,0	15,0	24,0	27,0	GE14SK03
S	R 1/2" keg	14	630	47,0	15,0	14,0	24,0	27,0	GE14SK04
S	R 1/2" keg	16	400	48,0	14,0	15,5	27,0	30,0	GE16SK04
S	R 3/4" keg	16	400	48,0	16,0	13,5	27,0	30,0	GE16SK06
S	R 1/2" keg	20	400	54,0	14,0	18,5	32,0	36,0	GE20SK04
S	R 3/4" keg	20	400	54,0	16,0	16,5	32,0	36,0	GE20SK06
S	R 1" keg	20	400	56,0	18,0	16,5	36,0	36,0	GE20SK08
S	R 3/4" keg	25	400	62,0	16,0	22,0	41,0	46,0	GE25SK06
S	R 1" keg	25	400	64,0	20,0	20,0	41,0	46,0	GE25SK08
S	R 1" keg	30	250	62,0	18,0	17,5	46,0	50,0	GE30SK08
S	R 1 1/4" keg	30	250	71,0	20,0	24,5	46,0	50,0	GE30SK10
S	R 1 1/2" keg	30	250	73,0	22,0	24,5	55,0	50,0	GE30SK12
S	R 1 1/4" keg	38	250	74,0	20,0	23,0	55,0	60,0	GE38SK10
S	R 1 1/2" keg	38	250	76,0	22,0	23,0	55,0	60,0	GE38SK12

**Gerade Einschraubverschraubung,
Einschraubgewinde NPT, leichte Reihe**
straight male stud coupling,
male thread NPT, light duty series

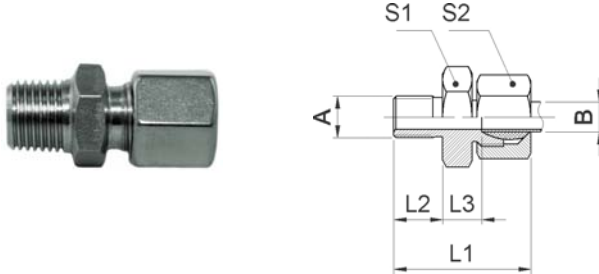

Reihe series	A / Gewinde thread	B / Rohr pipe	PN bar	L1 (mm)	L2 (mm)	L3 (mm)	S1 (mm)	S2 (mm)	Art. Nr. order no.
L	1/8" NPT	6	250	32,0	10,0	7,5	12,0	14,0	GE06LN01
L	1/4" NPT	6	250	38,0	15,0	8,5	17,0	14,0	GE06LN02
L	3/8" NPT	6	250	38,0	15,0	9,5	19,0	14,0	GE06LN03
L	1/2" NPT	6	250	44,0	20,0	8,5	22,0	14,0	GE06LN04
L	1/8" NPT	8	250	33,0	10,0	8,0	14,0	17,0	GE08LN01
L	1/4" NPT	8	250	38,0	15,0	8,0	17,0	17,0	GE08LN02
L	3/8" NPT	8	250	38,0	15,0	8,0	19,0	17,0	GE08LN03
L	1/2" NPT	8	250	44,0	20,0	9,0	22,0	17,0	GE08LN04
L	1/8" NPT	10	250	33,0	10,0	8,0	17,0	19,0	GE10LN01
L	1/4" NPT	10	250	39,0	15,0	9,0	17,0	19,0	GE10LN02
L	3/8" NPT	10	250	40,0	15,0	10,0	19,0	19,0	GE10LN03
L	1/2" NPT	10	250	45,0	20,0	11,0	22,0	22,0	GE10LN04
L	3/4" NPT	10	250	46,0	20,0	10,0	30,0	19,0	GE10LN06
L	1/8" NPT	12	250	34,0	10,0	9,0	19,0	22,0	GE12LN01
L	1/4" NPT	12	250	40,0	15,0	10,0	19,0	22,0	GE12LN02
L	3/8" NPT	12	250	40,0	15,0	10,0	19,0	22,0	GE12LN03
L	1/2" NPT	12	250	45,0	20,0	10,0	22,0	22,0	GE12LN04
L	3/4" NPT	12	250	47,0	20,0	12,0	30,0	22,0	GE12LN06
L	1/4" NPT	15	250	41,0	15,0	11,0	27,0	24,0	GE15LN02
L	3/8" NPT	15	250	41,0	15,0	11,0	24,0	27,0	GE15LN03
L	1/2" NPT	15	250	46,0	20,0	11,0	27,0	27,0	GE15LN04
L	3/4" NPT	15	250	47,0	20,0	12,0	30,0	27,0	GE15LN06
L	1" NPT	15	250	53,0	25,0	13,0	36,0	27,0	GE15LN08
L	3/8" NPT	18	160	43,0	15,0	11,5	27,0	32,0	GE18LN03
L	1/2" NPT	18	160	48,0	20,0	11,5	27,0	32,0	GE18LN04
L	3/4" NPT	18	160	48,0	20,0	11,5	30,0	32,0	GE18LN06
L	1" NPT	18	160	54,0	25,0	12,5	36,0	32,0	GE18LN08
L	3/8" NPT	22	160	45,0	15,0	13,5	32,0	36,0	GE22LN03
L	1/2" NPT	22	160	50,0	20,0	13,5	32,0	36,0	GE22LN04
L	3/4" NPT	22	160	50,0	20,0	13,5	32,0	36,0	GE22LN06
L	1" NPT	22	160	56,0	25,0	14,5	36,0	36,0	GE22LN08
L	1/2" NPT	28	100	51,0	20,0	14,5	41,0	41,0	GE28LN04
L	3/4" NPT	28	100	51,0	20,0	14,5	41,0	41,0	GE28LN06
L	1" NPT	28	100	56,0	25,0	14,5	41,0	41,0	GE28LN08
L	1 1/4" NPT	28	100	48,0	25,0	16,5	46,0	41,0	GE28LN10
L	1" NPT	35	100	61,0	25,0	14,5	46,0	50,0	GE35LN08
L	1 1/4" NPT	35	100	62,0	25,0	15,5	46,0	50,0	GE35LN10
L	1 1/2" NPT	35	100	62,0	26,0	14,5	55,0	50,0	GE35LN12
L	1 1/2" NPT	42	100	65,0	26,0	16,0	55,0	60,0	GE42LN12

**Gerade Einschraubverschraubung,
Einschraubgewinde NPT, schwere Reihe**
 straight male stud coupling,
 male thread NPT, heavy duty series

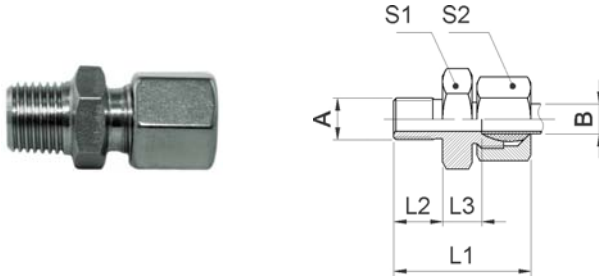

Reihe series	A / Gewinde thread	B / Rohr pipe	PN bar	L1 (mm)	L2 (mm)	L3 (mm)	S1 (mm)	S2 (mm)	Art. Nr. order no.
S	1/8" NPT	6	630	36,0	10,0	11,0	14,0	17,0	GE06SN01
S	1/4" NPT	6	630	43,0	15,0	13,0	17,0	17,0	GE06SN02
S	3/8" NPT	6	630	41,0	15,0	11,0	19,0	17,0	GE06SN03
S	1/2" NPT	6	630	50,0	20,0	15,0	22,0	17,0	GE06SN04
S	1/8" NPT	8	630	38,0	10,0	13,0	17,0	19,0	GE08SN01
S	1/4" NPT	8	630	43,0	15,0	13,0	17,0	19,0	GE08SN02
S	3/8" NPT	8	630	43,0	15,0	13,0	19,0	19,0	GE08SN03
S	1/2" NPT	8	630	50,0	20,0	15,0	22,0	19,0	GE08SN04
S	1/8" NPT	10	630	39,0	10,0	13,0	22,0	22,0	GE10SN01
S	1/4" NPT	10	630	44,0	15,0	13,0	19,0	22,0	GE10SN02
S	3/8" NPT	10	630	44,0	15,0	13,0	19,0	22,0	GE10SN03
S	1/2" NPT	10	630	51,0	20,0	15,0	22,0	22,0	GE10SN04
S	1/4" NPT	12	630	46,0	15,0	15,0	22,0	24,0	GE12SN02
S	3/8" NPT	12	630	46,0	15,0	15,0	22,0	24,0	GE12SN03
S	1/2" NPT	12	630	51,0	20,0	15,0	22,0	24,0	GE12SN04
S	3/4" NPT	12	630	53,0	20,0	17,0	30,0	24,0	GE12SN06
S	1" NPT	12	630	56,0	25,0	15,0	36,0	24,0	GE12SN08
S	1/4" NPT	14	630	49,0	15,0	16,0	24,0	27,0	GE14SN02
S	3/8" NPT	14	630	49,0	15,0	16,0	24,0	27,0	GE14SN03
S	1/2" NPT	14	630	54,0	20,0	16,0	24,0	27,0	GE14SN04
S	3/8" NPT	16	400	49,0	15,0	15,5	27,0	30,0	GE16SN03
S	1/2" NPT	16	400	54,0	20,0	15,5	27,0	30,0	GE16SN04
S	3/4" NPT	16	400	56,0	20,0	17,5	30,0	30,0	GE16SN06
S	1" NPT	16	400	63,0	25,0	19,5	36,0	30,0	GE16SN08
S	3/8" NPT	20	400	54,0	15,0	17,5	32,0	36,0	GE20SN03
S	1/2" NPT	20	400	59,0	20,0	17,5	32,0	36,0	GE20SN04
S	3/4" NPT	20	400	59,0	20,0	17,5	32,0	36,0	GE20SN06
S	1" NPT	20	400	66,0	25,0	19,5	36,0	36,0	GE20SN08
S	1 1/4" NPT	20	400	66,0	25,0	19,5	46,0	36,0	GE20SN10
S	1/2" NPT	25	400	64,0	20,0	20,0	36,0	46,0	GE25SN04
S	3/4" NPT	25	400	64,0	20,0	20,0	41,0	46,0	GE25SN06
S	1" NPT	25	400	69,0	25,0	20,0	41,0	46,0	GE25SN08
S	1 1/4" NPT	25	400	70,0	25,0	21,0	46,0	46,0	GE25SN10
S	1 1/2" NPT	25	400	73,0	26,0	23,0	50,0	46,0	GE25SN12
S	3/4" NPT	30	250	67,0	20,0	20,5	46,0	50,0	GE30SN06
S	1" NPT	30	250	72,0	25,0	20,5	46,0	50,0	GE30SN08
S	1 1/4" NPT	30	250	73,0	25,0	21,5	46,0	50,0	GE30SN10
S	1 1/2" NPT	30	250	73,0	26,0	20,5	50,0	50,0	GE30SN12

**Gerade Einschraubverschraubung,
Einschraubgewinde NPT, schwere Reihe**
straight male stud coupling,
male thread NPT, heavy duty series

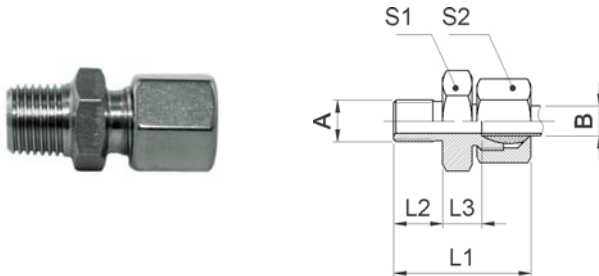

Reihe series	A / Gewinde thread	B / Rohr pipe	PN bar	L1 (mm)	L2 (mm)	L3 (mm)	S1 (mm)	S2 (mm)	Art. Nr. order no.
S	1" NPT	38	250	79,0	25,0	23,0	55,0	60,0	GE38SN08
S	1 1/4" NPT	38	250	80,0	25,0	24,0	55,0	60,0	GE38SN10
S	1 1/2" NPT	38	250	80,0	26,0	23,0	55,0	60,0	GE38SN12

**Winkel-Einschraubverschraubung,
Einschraubgewinde BSPT, leichte Reihe**
elbow male stud coupling,
male thread BSPT, light duty series

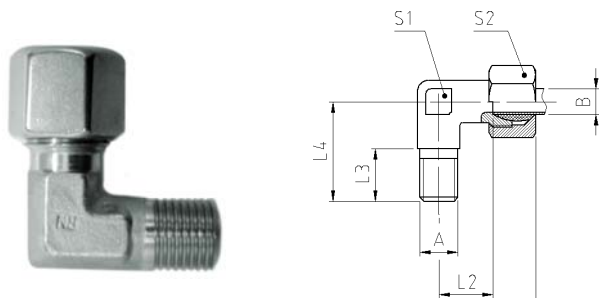

Reihe series	A / Gewinde thread	B / Rohr pipe	PN bar	L1 (mm)	L2 (mm)	L3 (mm)	L4 (mm)	S1 (mm)	S2 (mm)	Art. Nr. order no.
L	R 1/8" keg	6	250	27,0	12,0	8,0	20,0	12,0	14,0	WE06L01
L	R 1/4" keg	6	250	29,0	14,0	12,0	26,0	12,0	14,0	WE06L02
L	R 3/8" keg	6	250	30,0	17,0	12,0	31,5	17,0	14,0	WE06L03
L	R 1/2" keg	6	250	35,0	21,5	14,0	34,5	19,0	14,0	WE06L04
L	R 1/8" keg	8	250	29,0	14,0	8,0	26,0	14,0	17,0	WE08L01
L	R 1/4" keg	8	250	29,0	14,0	12,0	26,0	14,0	17,0	WE08L02
L	R 3/8" keg	8	250	32,0	27,0	12,0	28,0	19,0	17,0	WE08L03
L	R 1/2" keg	8	250	34,0	20,0	14,0	32,0	17,0	17,0	WE08L04
L	R 1/8" keg	10	250	30,0	15,5	8,0	22,0	14,0	19,0	WE10L01
L	R 1/4" keg	10	250	30,0	15,0	12,0	27,0	17,0	19,0	WE10L02
L	R 3/8" keg	10	250	32,0	17,0	12,0	28,0	19,0	19,0	WE10L03
L	R 1/2" keg	10	250	38,0	22,0	14,0	32,0	17,0	19,0	WE10L04
L	R 1/8" keg	12	250	32,0	16,0	8,0	28,0	17,0	22,0	WE12L01
L	R 1/4" keg	12	250	32,0	17,0	12,0	27,0	19,0	22,0	WE12L02
L	R 3/8" keg	12	250	32,0	17,0	12,0	28,0	19,0	22,0	WE12L03
L	R 1/2" keg	12	250	36,0	21,0	14,0	34,0	19,0	22,0	WE12L04

**Winkel-Einschraubverschraubung,
Einschraubgewinde BSPT, leichte + schwere Reihe**
elbow male stud coupling,
male thread BSPT, light + heavy duty series

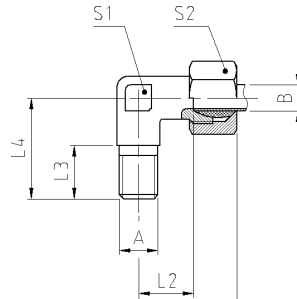

Reihe series	A / Gewinde thread	B / Rohr pipe	PN bar	L1 (mm)	L2 (mm)	L3 (mm)	L4 (mm)	S1 (mm)	S2 (mm)	Art. Nr. order no.
L	R 1/4" keg	15	250	34,5	21,5	12,0	28,5	19,0	27,0	WE15L02
L	R 3/8" keg	15	250	35,0	20,5	12,0	28,5	19,0	27,0	WE15L03
L	R 1/2" keg	15	250	36,0	21,0	14,0	34,0	19,0	27,0	WE15L04
L	R 3/8" keg	18	160	39,0	24,0	12,0	30,0	24,0	32,0	WE18L03
L	R 1/2" keg	18	160	40,0	23,5	14,0	36,0	24,0	32,0	WE18L04
L	R 3/4" keg	18	160	44,0	29,0	16,0	44,0	27,0	32,0	WE18LK06
L	R 1/2" keg	22	160	44,0	27,0	14,0	44,0	27,0	36,0	WE22L04
L	R 3/4" keg	22	160	44,0	27,0	16,0	44,0	27,0	36,0	WE22LK06
L	R 1" keg	22	160	46,0	27,5	18,0	46,0	27,0	36,0	WE22LK08
L	R 3/4" keg	28	100	47,0	30,0	16,0	44,0	36,0	41,0	WE28LK06
L	R 1" keg	28	100	49,0	32,5	18,0	47,5	36,0	41,0	WE28LK08

Reihe series	A / Gewinde thread	B / Rohr pipe	PN bar	L1 (mm)	L2 (mm)	L3 (mm)	L4 (mm)	S1 (mm)	S2 (mm)	Art. Nr. order no.
S	R 1/4" keg	6	630	31,0	16,0	12,0	26,0	14,0	17,0	WE06S02
S	R 3/8" keg	6	630	33,0	18,0	12,0	20,0	14,0	17,0	WE06S03
S	R 1/2" keg	6	630	34,0	20,0	14,0	32,0	20,0	17,0	WE06S04
S	R 1/8" keg	8	630	32,0	17,5	8,0	27,5	14,0	19,0	WE08S01
S	R 1/4" keg	8	630	32,0	17,0	12,0	27,0	17,0	19,0	WE08S02
S	R 3/8" keg	8	630	33,0	18,0	12,0	28,0	17,0	19,0	WE08S03
S	R 1/2" keg	8	630	35,0	20,5	14,0	34,0	19,0	19,0	WE08S04
S	R 1/4" keg	10	630	34,0	17,5	12,0	28,0	22,0	22,0	WE10S02
S	R 3/8" keg	10	630	34,0	17,5	12,0	28,0	19,0	22,0	WE10S03
S	R 1/2" keg	10	630	39,0	22,5	14,0	32,0	22,0	22,0	WE10S04
S	R 1/4" keg	12	630	37,0	21,5	12,0	28,5	17,0	24,0	WE12S02
S	R 3/8" keg	12	630	38,0	21,5	12,0	28,0	19,0	24,0	WE12S03
S	R 1/2" keg	12	630	39,0	22,5	14,0	32,0	19,0	24,0	WE12S04
S	R 3/8" keg	14	630	40,0	22,0	12,0	30,0	19,0	27,0	WE14S03
S	R 1/2" keg	14	630	40,0	22,0	14,0	32,0	19,0	27,0	WE14S04
S	R 3/8" keg	16	400	42,0	24,5	12,0	32,0	24,0	30,0	WE16S03
S	R 1/2" keg	16	400	43,0	24,5	14,0	32,0	24,0	30,0	WE16S04
S	R 1/2" keg	20	400	47,0	26,5	14,0	36,5	27,0	36,0	WE20S04
S	R 3/4" keg	20	400	47,0	26,5	16,0	43,0	27,0	36,0	WE20SK06
S	R 3/4" keg	25	400	52,0	27,5	16,0	44,5	35,0	46,0	WE25SK06

**Winkel-Einschraubverschraubung,
Einschraubgewinde BSPP mit Dichtkante Form B, leichte + schwere Reihe**
elbow male stud coupling,
male thread BSPP with sealing edge form B, light + heavy duty series

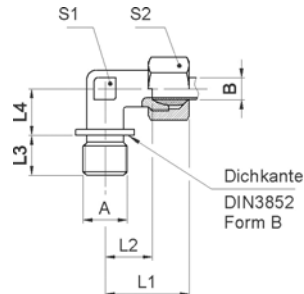

Reihe series	A / Gewinde thread	B / Rohr pipe	PN bar	L1 (mm)	L2 (mm)	L3 (mm)	L4 (mm)	S1 (mm)	S2 (mm)	Art. Nr. order no.
L	G 3/4"	22	160	44,0	27,5	16,0	26,0	27,0	36,0	WE22L06
L	G 1"	22	160	47,0	30,5	18,0	43,5	36,0	36,0	WE22L08
L	G 1 1/4"	22	160	51,0	34,5	20,0	34,0	41,0	36,0	WE22L10
L	G 3/4"	28	100	48,5	31,0	16,0	43,5	36,0	41,0	WE28L06
L	G 1"	28	100	47,0	30,5	18,0	30,0	36,0	41,0	WE28L08
L	G 1 1/4"	35	100	51,5	34,5	20,0	34,0	41,0	50,0	WE35L10
L	G 1 1/2"	35	100	50,5	40,0	22,0	39,0	50,0	50,0	WE35L12
L	G 1 1/4"	42	100	63,0	40,0	20,0	39,0	50,0	60,0	WE42L10
L	G 1 1/2"	42	100	63,0	40,0	22,0	39,0	50,0	60,0	WE42L12
L	G 3/4"	22	160	44,0	27,5	16,0	26,0	27,0	36,0	WE22L06
L	G 1"	22	160	47,0	30,5	18,0	43,5	36,0	36,0	WE22L08
L	G 1 1/4"	22	160	51,0	34,5	20,0	34,0	41,0	36,0	WE22L10
L	G 3/4"	28	100	48,5	31,0	16,0	43,5	36,0	41,0	WE28L06
L	G 1"	28	100	47,0	30,5	18,0	30,0	36,0	41,0	WE28L08
L	G 1 1/4"	35	100	51,5	34,5	20,0	34,0	41,0	50,0	WE35L10
L	G 1 1/2"	35	100	50,5	40,0	22,0	39,0	50,0	50,0	WE35L12
L	G 1 1/4"	42	100	63,0	40,0	20,0	39,0	50,0	60,0	WE42L10
L	G 1 1/2"	42	100	63,0	40,0	22,0	39,0	50,0	60,0	WE42L12

Reihe series	A / Gewinde thread	B / Rohr pipe	PN bar	L1 (mm)	L2 (mm)	L3 (mm)	L4 (mm)	S1 (mm)	S2 (mm)	Art. Nr. order no.
S	G 3/4"	20	400	48,0	26,5	16,0	26,0	27,0	36,0	WE20S06
S	G 3/4"	25	400	54,0	30,0	16,0	32,5	35,0	40,0	WE25S06
S	G 1"	25	400	54,0	30,0	18,0	30,0	36,0	46,0	WE25S08
S	G 1"	30	250	65,0	37,0	18,0	40,0	41,0	50,0	WE30S08
S	G 1 1/4"	30	250	62,0	35,5	20,0	34,0	41,0	50,0	WE30S10
S	G 1 1/2"	38	250	72,0	41,0	22,0	39,0	50,0	60,0	WE38S12

**Winkel-Einschraubverschraubung,
Einschraubgewinde NPT, leichte Reihe**
elbow male stud coupling,
male thread NPT, light duty series

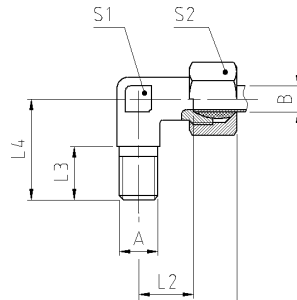

Reihe series	A / Gewinde thread	B / Rohr pipe	PN bar	L1 (mm)	L2 (mm)	L3 (mm)	L4 (mm)	S1 (mm)	S2 (mm)	Art. Nr. order no.
L	1/8" NPT	6	250	26,5	12,0	10,0	20,0	12,0	14,0	WE06LN01
L	1/4" NPT	6	250	28,5	14,0	14,5	26,0	14,0	14,0	WE06LN02
L	3/8" NPT	6	250	32,5	18,0	14,5	28,0	14,0	14,0	WE06LN03
L	1/8" NPT	8	250	29,0	14,0	10,0	26,0	14,0	17,0	WE08LN01
L	1/4" NPT	8	250	29,0	14,0	14,5	26,0	14,0	17,0	WE08LN02
L	3/8" NPT	8	250	32,5	17,5	14,5	28,0	14,0	17,0	WE08LN03
L	1/2" NPT	8	250	35,5	20,5	20,0	34,0	19,0	17,0	WE08LN04
L	1/8" NPT	10	250	32,5	17,5	10,0	25,5	14,0	19,0	WE10LN01
L	1/4" NPT	10	250	30,0	15,0	14,5	27,0	17,0	19,0	WE10LN02
L	3/8" NPT	10	250	32,0	17,0	14,5	28,0	19,0	19,0	WE10LN03
L	1/2" NPT	10	250	36,0	21,0	20,0	34,0	20,0	19,0	WE10LN04
L	1/4" NPT	12	250	32,0	17,0	14,5	28,0	19,0	22,0	WE12LN02
L	3/8" NPT	12	250	32,0	17,0	14,5	28,0	19,0	22,0	WE12LN03
L	1/2" NPT	12	250	36,0	21,0	20,0	34,0	19,0	22,0	WE12LN04
L	3/8" NPT	15	250	36,0	21,0	14,5	32,0	19,0	27,0	WE15LN03
L	1/2" NPT	15	250	36,0	21,0	20,0	34,0	19,0	27,0	WE15LN04
L	3/4" NPT	15	250	44,0	29,0	20,0	44,0	27,0	27,0	WE15LN06
L	1/2" NPT	18	160	40,0	23,5	20,0	36,0	24,0	32,0	WE18LN04
L	3/4" NPT	18	160	45,5	29,0	20,0	44,0	27,0	32,0	WE18LN06
L	3/4" NPT	22	160	44,0	27,5	20,0	42,0	27,0	36,0	WE22LN06
L	1" NPT	28	100	47,0	30,5	25,0	48,0	36,0	41,0	WE28LN08
L	1 1/4" NPT	35	100	56,0	34,5	25,0	54,0	41,0	50,0	WE35LN10
L	1 1/2" NPT	42	100	63,0	40,0	26,0	61,0	50,0	60,0	WE42LN12

**Winkel-Einschraubverschraubung,
Einschraubgewinde NPT, schwere Reihe**
elbow male stud coupling,
male thread NPT, heavy duty series

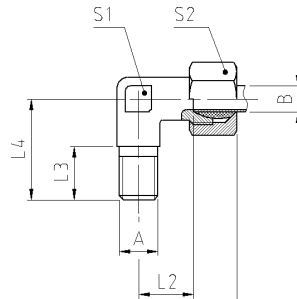

Reihe series	A / Gewinde thread	B / Rohr pipe	PN bar	L1 (mm)	L2 (mm)	L3 (mm)	L4 (mm)	S1 (mm)	S2 (mm)	Art. Nr. order no.
S	1/4" NPT	6	630	31,0	16,0	14,5	26,0	14,0	17,0	WE06SN02
S	3/8" NPT	6	630	33,0	18,0	14,5	28,0	17,0	17,0	WE06SN03
S	1/2" NPT	6	630	36,0	21,0	20,0	34,0	19,0	17,0	WE06SN04
S	1/4" NPT	8	630	32,0	17,0	14,5	27,0	17,0	19,0	WE08SN02
S	3/8" NPT	8	630	33,0	18,0	14,5	28,0	17,0	19,0	WE08SN03
S	1/2" NPT	8	630	38,0	23,0	20,0	34,0	19,0	19,0	WE08SN04
S	1/4" NPT	10	630	33,5	17,5	14,5	28,0	19,0	22,0	WE10SN02
S	3/8" NPT	10	630	33,5	17,5	14,5	28,0	19,0	22,0	WE10SN03
S	1/2" NPT	10	630	34,5	18,5	20,0	32,0	20,0	22,0	WE10SN04
S	1/4" NPT	12	630	37,5	21,5	14,5	29,0	17,0	24,0	WE12SN02
S	3/8" NPT	12	630	38,5	22,5	14,5	28,0	22,0	24,0	WE12SN03
S	1/2" NPT	12	630	38,5	22,5	20,0	34,0	19,0	24,0	WE12SN04
S	3/8" NPT	14	630	40,0	22,0	14,5	34,0	19,0	27,0	WE14SN03
S	1/2" NPT	14	630	40,0	22,0	20,0	34,0	19,0	27,0	WE14SN04
S	3/8" NPT	16	400	43,5	25,0	14,5	35,0	24,0	30,0	WE16SN03
S	1/2" NPT	16	400	43,0	24,5	20,0	36,0	24,0	30,0	WE16SN04
S	3/4" NPT	16	400	43,0	24,5	20,0	38,0	24,0	30,0	WE16SN06
S	1/2" NPT	20	400	48,0	26,5	20,0	42,0	27,0	36,0	WE20SN04
S	3/4" NPT	20	400	48,0	26,5	20,0	42,0	27,0	36,0	WE20SN06
S	1" NPT	20	400	51,5	30,0	25,0	48,0	36,0	36,0	WE20SN08
S	1" NPT	25	400	54,0	30,0	25,0	48,0	36,0	46,0	WE25SN08
S	1 1/4" NPT	30	250	62,0	35,5	25,0	54,0	41,0	50,0	WE30SN10
S	1 1/2" NPT	38	250	72,0	41,0	26,0	61,0	50,0	60,0	WE38SN12

T-Einschraubverschraubungen T-male stud couplings

T-Einschraubverschraubung,
Einschraubgewinde BSPT, leichte + schwere Reihe
T-male stud coupling,
male thread BSPT, light + heavy duty series

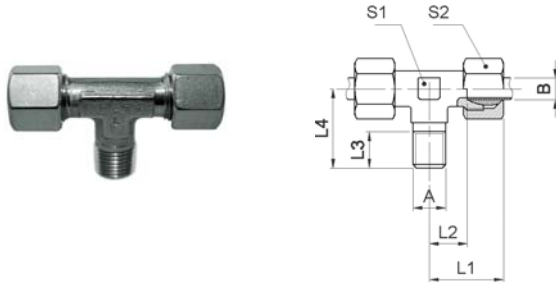

Reihe series	A / Gewinde thread	B / Rohr pipe	PN bar	L1 (mm)	L2 (mm)	L3 (mm)	L4 (mm)	S1 (mm)	S2 (mm)	Art. Nr. order no.
L	R 1/8" keg	6	250	27,0	12,0	8,0	20,0	12,0	14,0	TE06L01
L	R 1/4" keg	6	250	27,0	12,0	12,0	26,5	12,0	14,0	TE06L02
L	R 1/4" keg	8	250	29,0	14,0	12,0	26,0	12,0	17,0	TE08L02
L	R 3/8" keg	8	250	30,0	15,0	12,0	28,0	19,0	17,0	TE08L03
L	R 1/2" keg	8	250	36,0	21,0	14,0	32,0	17,0	17,0	TE08L04
L	R 1/4" keg	10	250	30,0	15,0	12,0	27,0	14,0	19,0	TE10L02
L	R 3/8" keg	10	250	30,0	15,0	12,0	27,0	14,0	19,0	TE10L03
L	R 1/2" keg	10	250	41,0	27,0	14,0	32,0	24,0	19,0	TE10L04
L	R 1/4" keg	12	250	32,0	17,0	12,0	27,0	19,0	22,0	TE12L02
L	R 3/8" keg	12	250	32,0	17,0	12,0	28,0	17,0	22,0	TE12L03
L	R 1/2" keg	12	250	36,0	21,0	14,0	34,0	19,0	22,0	TE12L04
L	R 3/8" keg	15	250	36,0	21,0	12,0	28,0	19,0	27,0	TE15L03
L	R 1/2" keg	15	250	36,0	21,0	14,0	34,0	19,0	27,0	TE15L04
L	R 1/4" keg	18	160	40,0	23,5	12,0	30,0	24,0	32,0	TE18L02
L	R 3/8" keg	18	160	40,0	23,5	12,0	30,0	24,0	32,0	TE18L03
L	R 1/2" keg	18	160	40,0	23,5	14,0	36,0	24,0	32,0	TE18L04

Reihe series	A / Gewinde thread	B / Rohr pipe	PN bar	L1 (mm)	L2 (mm)	L3 (mm)	L4 (mm)	S1 (mm)	S2 (mm)	Art. Nr. order no.
S	R 1/4" keg	6	630	31,0	16,0	12,0	26,0	14,0	17,0	TE06S02
S	R 1/4" keg	8	630	32,0	17,0	12,0	27,0	17,0	19,0	TE08S02
S	R 3/8" keg	10	630	34,0	17,5	12,0	28,0	19,0	22,0	TE10S03
S	R 1/2" keg	12	630	39,0	22,5	14,0	32,0	19,0	24,0	TE12S04
S	R 1/2" keg	14	630	40,0	22,0	14,0	32,0	19,0	27,0	TE14S04

**T-Einschraubverschraubung,
mit Dichtkante Form B ; leichte + schwere Reihe**
T-male stud coupling,
with sealing edge form B, light + heavy duty series

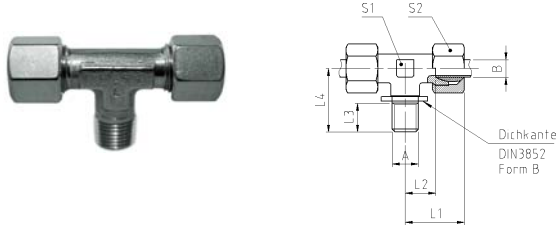

Reihe series	A / Gewinde thread	B / Rohr pipe	PN bar	L1 (mm)	L2 (mm)	L3 (mm)	L4 (mm)	S1 (mm)	S2 (mm)	Art. Nr. order no.
L	G 3/4"	22	160	44,0	27,5	16,0	26,0	27,0	36,0	TE22L06
L	G 1"	28	100	47,0	30,5	18,0	30,0	36,0	41,0	TE28L08
L	G 1 1/4"	35	100	51,5	34,5	20,0	34,0	41,0	50,0	TE35L10
L	G 1 1/2"	42	100	63,0	40,0	22,0	39,0	50,0	60,0	TE42L12

Reihe series	A / Gewinde thread	B / Rohr pipe	PN bar	L1 (mm)	L2 (mm)	L3 (mm)	L4 (mm)	S1 (mm)	S2 (mm)	Art. Nr. order no.
S	G 3/4"	20	400	48,0	26,5	16,0	26,0	27,0	36,0	TE20S06
S	G 1"	25	400	54,0	30,0	18,0	30,0	36,0	46,0	TE25S08
S	G 1 1/4"	30	250	62,0	35,5	20,0	34,0	41,0	50,0	TE30S10
S	G 1 1/2"	38	250	72,0	41,0	22,0	39,0	50,0	60,0	TE38S12

**T-Einschraubverschraubung,
Einschraubgewinde NPT, leichte Reihe**
T-male stud coupling,
male thread NPT, light duty series

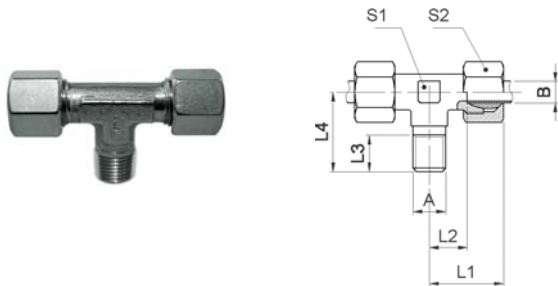

Reihe series	A / Gewinde thread	B / Rohr pipe	PN bar	L1 (mm)	L2 (mm)	L3 (mm)	L4 (mm)	S1 (mm)	S2 (mm)	Art. Nr. order no.
L	1/8" NPT	6	250	26,5	12,0	10,0	20,0	12,0	14,0	TE06LN01
L	1/4" NPT	8	250	29,0	14,0	14,5	26,0	14,0	17,0	TE08LN02
L	1/4" NPT	10	250	30,0	15,0	14,5	27,0	17,0	19,0	TE10LN02
L	3/8" NPT	12	250	32,0	17,0	14,5	28,0	19,0	22,0	TE12LN03
L	1/2" NPT	12	250	36,0	21,0	20,0	34,0	19,0	22,0	TE12LN04
L	1/2" NPT	15	250	36,0	21,0	20,0	34,0	19,0	27,0	TE15LN04
L	1/2" NPT	18	160	40,0	23,5	20,0	36,0	24,0	32,0	TE18LN04
L	3/4" NPT	22	160	44,0	27,5	20,0	42,0	27,0	36,0	TE22LN06
L	1" NPT	28	100	47,0	30,5	25,0	48,0	36,0	41,0	TE28LN08
L	1 1/4" NPT	35	100	56,0	34,5	25,0	54,0	41,0	50,0	TE35LN10

**T-Einschraubverschraubung,
Einschraubgewinde NPT, schwere Reihe**
T-male stud coupling,
male thread NPT, heavy duty series

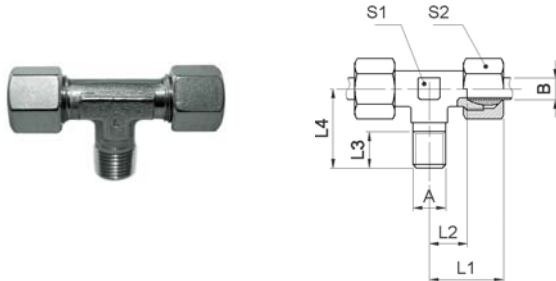

Reihe series	A / Gewinde thread	B / Rohr pipe	PN bar	L1 (mm)	L2 (mm)	L3 (mm)	L4 (mm)	S1 (mm)	S2 (mm)	Art. Nr. order no.
S	1/4" NPT	6	630	31,0	16,0	14,5	26,0	14,0	17,0	TE06SN02
S	1/4" NPT	8	630	32,0	17,0	14,5	27,0	17,0	19,0	TE08SN02
S	3/8" NPT	10	630	33,5	17,5	14,5	28,0	19,0	22,0	TE10SN03
S	3/8" NPT	12	630	38,5	22,5	14,5	28,0	22,0	24,0	TE12SN03
S	1/2" NPT	14	630	40,0	22,0	20,0	34,0	19,0	27,0	TE14SN04
S	1/2" NPT	16	400	43,0	24,5	20,0	36,0	24,0	30,0	TE16SN04
S	3/4" NPT	20	400	48,0	26,5	20,0	42,0	27,0	36,0	TE20SN06
S	1" NPT	25	400	54,0	30,0	25,0	48,0	36,0	46,0	TE25SN08
S	1 1/4" NPT	30	250	62,0	35,5	25,0	54,0	41,0	50,0	TE30SN10
S	1 1/2" NPT	38	250	72,0	41,0	26,0	61,0	50,0	60,0	TE38SN12

Einschraubverschraubungen L-male stud couplings

L-Einschraubverschraubung,
Einschraubgewinde BSPP mit Dichtkante Form B, leichte + schwere Reihe
L-male stud coupling,
male thread BSPP with sealing edge form B, light + heavy duty series

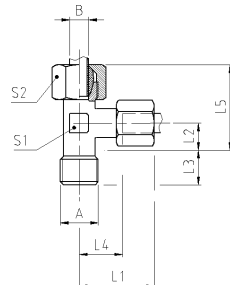

Reihe series	A / Gewinde thread	B / Rohr pipe	PN bar	L1 (mm)	L2 (mm)	L3 (mm)	L4 (mm)	L5 (mm)	S1 (mm)	S2 (mm)	Art. Nr. order no.
L	R 1/8" keg	6	250	27,0	20,0	8,0	12,0	32,0	12,0	14,0	LE06L01
L	R 1/4" keg	6	250	29,0	26,0	12,0	14,0	40,0	12,0	14,0	LE06L02
L	R 1/4" keg	8	250	29,0	26,0	12,0	14,0	40,0	14,0	17,0	LE08L02
L	R 3/8" keg	8	250	32,0	28,0	12,0	27,0	55,0	19,0	17,0	LE08L03
L	R 1/2" keg	8	250	34,0	32,0	14,0	20,0	52,0	17,0	17,0	LE08L04
L	R 1/4" keg	10	250	30,0	27,0	12,0	15,0	42,0	17,0	19,0	LE10L02
L	R 3/8" keg	10	250	32,0	28,0	12,0	17,0	45,0	19,0	19,0	LE10L03
L	R 1/2" keg	10	250	38,0	32,0	14,0	22,0	54,0	17,0	19,0	LE10L04
L	R 1/4" keg	12	250	32,0	27,0	12,0	17,0	44,0	19,0	22,0	LE12L02
L	R 3/8" keg	12	250	32,0	28,0	12,0	17,0	45,0	19,0	22,0	LE12L03
L	R 1/2" keg	12	250	36,0	34,0	14,0	21,0	55,0	19,0	22,0	LE12L04
L	R 1/4" keg	15	250	34,5	28,5	12,0	21,5	50,0	19,0	27,0	LE15L02
L	R 3/8" keg	15	250	35,0	28,5	12,0	20,5	49,0	19,0	27,0	LE15L03
L	R 1/2" keg	15	250	36,0	34,0	14,0	21,0	55,0	19,0	27,0	LE15L04
L	R 3/8" keg	18	160	39,0	30,0	12,0	24,0	54,0	24,0	32,0	LE18L03
L	R 1/2" keg	18	160	40,0	36,0	14,0	23,5	60,0	24,0	32,0	LE18L04

Reihe series	A / Gewinde thread	B / Rohr pipe	PN bar	L1 (mm)	L2 (mm)	L3 (mm)	L4 (mm)	L5 (mm)	S1 (mm)	S2 (mm)	Art. Nr. order no.
S	R 1/4" keg	6	630	31,0	26,0	12,0	16,0	42,0	14,0	17,0	LE06S02
S	R 1/4" keg	8	630	32,0	27,0	12,0	17,0	44,0	17,0	19,0	LE08S02
S	R 3/8" keg	8	630	33,0	28,0	12,0	18,0	46,0	17,0	19,0	LE08S03
S	R 1/4" keg	10	630	34,0	28,0	12,0	17,5	45,5	22,0	22,0	LE10S02
S	R 3/8" keg	10	630	34,0	28,0	12,0	17,5	45,5	19,0	22,0	LE10S03
S	R 1/2" keg	10	630	39,0	32,0	14,0	22,5	54,5	22,0	22,0	LE10S04
S	R 1/4" keg	12	630	37,0	28,5	12,0	21,5	49,5	17,0	24,0	LE12S02
S	R 3/8" keg	12	630	38,0	28,0	12,0	21,5	49,5	19,0	24,0	LE12S03
S	R 1/2" keg	12	630	39,0	32,0	14,0	22,5	54,5	19,0	24,0	LE12S04
S	R 1/2" keg	14	630	40,0	32,0	14,0	22,0	54,0	19,0	27,0	LE14S04
S	R 1/2" keg	16	400	43,0	32,0	14,0	24,5	56,5	24,0	30,0	LE16S04

**L-Einschraubverschraubung,
Einschraubgewinde BSPP mit Dichtkante Form B, leichte + schwere Reihe**
L-male stud coupling,
male thread BSPP with sealing edge form B, light + heavy duty series

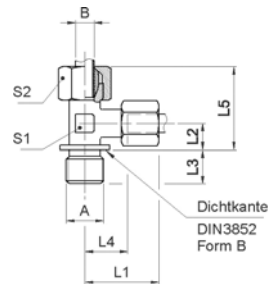

Reihe series	A / Gewinde thread	B / Rohr pipe	PN bar	L1 (mm)	L2 (mm)	L3 (mm)	L4 (mm)	L5 (mm)	S1 (mm)	S2 (mm)	Art. Nr. order no.
L	G 3/4"	22	160	44,0	26,0	16,0	27,5	53,5	27,0	36,0	LE22L06
L	G 1"	22	160	47,0	34,5	18,0	30,5	65,0	36,0	36,0	LE22L08
L	G 1"	28	100	47,0	30,0	18,0	30,5	60,5	36,0	41,0	LE28L08
L	G 1 1/4"	35	100	51,5	34,0	20,0	34,5	68,5	41,0	50,0	LE35L10
L	G 1 1/2"	42	100	63,0	39,0	22,0	40,0	79,0	50,0	60,0	LE42L12

Reihe series	A / Gewinde thread	B / Rohr pipe	PN bar	L1 (mm)	L2 (mm)	L3 (mm)	L4 (mm)	L5 (mm)	S1 (mm)	S2 (mm)	Art. Nr. order no.
S	G 3/4"	20	400	48,0	26,0	16,0	26,5	52,5	27,0	36,0	LE20S06
S	G 1"	25	400	54,0	30,0	18,0	30,0	60,0	36,0	46,0	LE25S08
S	G 1 1/4"	30	250	62,0	34,0	20,0	35,7	69,5	41,0	50,0	LE30S10
S	G 1 1/2"	38	250	72,0	39,0	22,0	41,0	80,0	50,0	60,0	LE38S12

**L-Einschraubverschraubung,
Einschraubgewinde NPT, leichte + schwere Reihe**
L-male stud coupling,
male thread NPT, light + heavy duty series

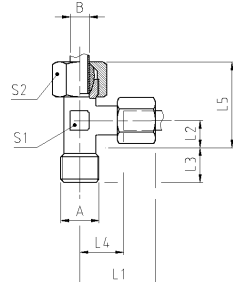

Reihe series	A / Gewinde thread	B / Rohr pipe	PN bar	L1 (mm)	L2 (mm)	L3 (mm)	L4 (mm)	L5 (mm)	S1 (mm)	S2 (mm)	Art. Nr. order no.
L	1/8" NPT	6	250	26,5	20,0	10,0	12,0	46,5	12,0	14,0	LE06LN01
L	1/4" NPT	8	250	29,0	26,0	14,5	14,0	55,0	14,0	17,0	LE08LN02
L	1/4" NPT	10	250	30,0	27,0	14,5	15,0	57,0	17,0	19,0	LE10LN02
L	3/8" NPT	12	250	32,0	28,0	14,5	17,0	60,0	19,0	22,0	LE12LN03
L	1/2" NPT	15	250	36,0	34,0	20,0	21,0	70,0	19,0	27,0	LE15LN04
L	1/2" NPT	18	160	40,0	36,0	20,0	23,5	76,0	24,0	32,0	LE18LN04
L	3/4" NPT	22	160	44,0	42,0	20,0	27,5	86,0	27,0	36,0	LE22LN06
L	1" NPT	28	100	47,0	48,0	25,0	30,5	95,0	36,0	41,0	LE28LN08
L	1 1/4" NPT	35	100	56,0	54,0	25,0	34,5	110,0	41,0	50,0	LE35LN10
L	1 1/2" NPT	42	100	63,0	61,0	26,0	40,0	124,0	50,0	60,0	LE42LN12

Reihe series	A / Gewinde thread	B / Rohr pipe	PN bar	L1 (mm)	L2 (mm)	L3 (mm)	L4 (mm)	L5 (mm)	S1 (mm)	S2 (mm)	Art. Nr. order no.
S	1/4" NPT	6	630	31,0	26,0	14,5	16,0	57,0	14,0	17,0	LE06SN02
S	1/4" NPT	8	630	32,0	27,0	14,5	17,0	59,0	17,0	19,0	LE08SN02
S	3/8" NPT	10	630	33,5	28,0	14,5	17,5	61,5	19,0	22,0	LE10SN03
S	3/8" NPT	12	630	38,5	28,0	14,5	22,5	66,5	22,0	24,0	LE12SN03
S	1/2" NPT	14	630	40,0	34,0	20,0	22,0	74,0	19,0	27,0	LE14SN04
S	1/2" NPT	16	400	43,0	36,0	20,0	24,5	79,0	24,0	30,0	LE16SN04
S	3/4" NPT	20	400	48,0	42,0	20,0	26,5	90,0	27,0	36,0	LE20SN06
S	1" NPT	25	400	54,0	48,0	25,0	30,0	102,0	36,0	46,0	LE25SN08
S	1 1/4" NPT	30	250	62,0	54,0	25,0	35,5	116,0	41,0	50,0	LE30SN10
S	1 1/2" NPT	38	250	72,0	61,0	26,0	41,0	133,0	50,0	60,0	LE38SN12

Gerade Aufschraubverschraubungen Straight female couplings

Gerade Aufschraubverschraubung,
Aufschraubgewinde BSPP, leichte Reihe
raight female coupling,
female thread BSPP, light duty series

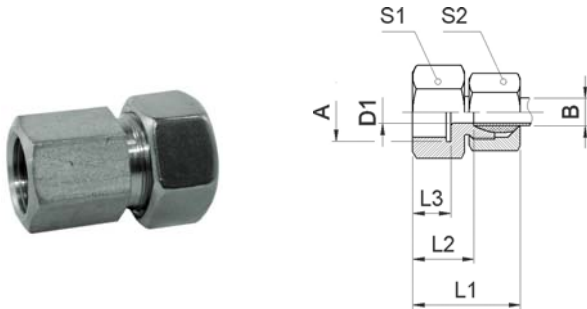

Reihe series	A / Gewinde thread	B / Rohr pipe	PN bar	L1 (mm)	L2 (mm)	L3 (mm)	S1 (mm)	S2 (mm)	D (mm)	Art. Nr. order no.
L	G 1/8"	6	250	34,0	19,0	12,0	14,0	14,0	4,0	GAI06L01
L	G 1/4"	6	250	39,0	24,0	17,0	19,0	14,0	4,0	GAI06L02
L	G 3/8"	6	250	41,0	27,0	17,0	22,0	14,0	4,0	GAI06L03
L	G 1/2"	6	250	45,0	30,0	22,0	27,0	14,0	4,0	GAI06L04
L	G 1/8"	8	250	35,0	20,0	12,0	17,0	17,0	6,0	GAI08L01
L	G 1/4"	8	250	39,0	24,0	17,0	19,0	17,0	6,0	GAI08L02
L	G 3/8"	8	250	42,0	26,5	17,0	24,0	17,0	6,0	GAI08L03
L	G 1/2"	8	250	44,0	29,0	20,0	27,0	17,0	6,0	GAI08L04
L	G 3/4"	8	250	44,0	29,0	20,0	32,0	17,0	6,0	GAI08L06
L	G 1/8"	10	250	35,0	20,0	12,0	19,0	19,0	8,0	GAI10L01
L	G 1/4"	10	250	40,0	25,0	17,0	19,0	19,0	8,0	GAI10L02
L	G 3/8"	10	250	41,0	26,0	17,0	22,0	19,0	8,0	GAI10L03
L	G 1/2"	10	250	45,0	31,0	20,0	27,0	19,0	8,0	GAI10L04
L	G 1/4"	12	250	41,0	26,0	17,0	19,0	22,0	10,0	GAI12L02
L	G 3/8"	12	250	41,0	26,0	17,0	24,0	22,0	10,0	GAI12L03
L	G 1/2"	12	250	45,0	30,0	20,0	27,0	22,0	10,0	GAI12L04
L	G 3/4"	12	250	51,0	36,0	20,0	36,0	22,0	10,0	GAI12L06
L	G 1/4"	15	250	42,0	26,0	17,0	22,0	27,0	12,0	GAI15L02
L	G 3/8"	15	250	42,0	26,0	17,0	24,0	27,0	12,0	GAI15L03
L	G 1/2"	15	250	46,0	31,0	20,0	27,0	27,0	12,0	GAI15L04
L	G 3/8"	18	160	43,0	26,5	17,0	27,0	32,0	15,0	GAI18L03
L	G 1/2"	18	160	46,0	30,5	20,0	27,0	32,0	15,0	GAI18L04
L	G 3/4"	18	160	46,0	31,0	20,0	32,0	32,0	15,0	GAI18L06
L	G 1"	18	160	52,0	35,0	24,0	41,0	32,0	15,0	GAI18L08
L	G 1/2"	22	160	52,0	34,5	22,0	32,0	36,0	18,5	GAI22L04
L	G 3/4"	22	160	52,0	35,5	22,0	32,0	36,0	19,0	GAI22L06
L	G 1"	22	160	56,0	39,0	24,0	41,0	36,0	19,0	GAI22L08
L	G 3/4"	28	100	54,0	35,5	20,0	41,0	41,0	24,0	GAI28L06
L	G 1"	28	100	55,0	38,0	24,0	41,0	41,0	24,0	GAI28L08
L	G 1"	35	100	60,0	39,5	24,0	46,0	50,0	30,0	GAI35L08
L	G 1 1/4"	35	100	63,0	41,0	25,0	55,0	50,0	30,0	GAI35L10
L	G 1 1/2"	42	100	65,0	42,5	26,0	60,0	60,0	36,0	GAI42L12

**Gerade Aufschraubverschraubung,
Aufschraubgewinde BSPP, schwere Reihe**
straight female coupling,
female thread BSPP, heavy duty series

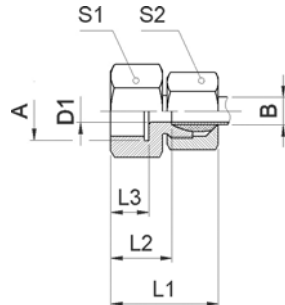

Reihe series	A / Gewinde thread	B / Rohr pipe	PN bar	L1 (mm)	L2 (mm)	L3 (mm)	S1 (mm)	S2 (mm)	D (mm)	Art. Nr. order no.
S	G 1/4"	6	630	41,0	26,0	17,0	19,0	17,0	4,0	GAI06S02
S	G 1/4"	8	630	41,0	26,0	17,0	19,0	19,0	5,0	GAI08S02
S	G 1/2"	8	630	46,0	32,0	20,0	27,0	19,0	5,0	GAI08S04
S	G 3/8"	10	630	43,0	26,5	17,0	22,0	22,0	7,0	GAI10S03
S	G 1/2"	10	630	46,0	31,0	20,0	27,0	22,0	7,0	GAI10S04
S	G 1/4"	12	630	43,0	26,5	17,0	22,0	24,0	8,0	GAI12S02
S	G 3/8"	12	630	43,0	26,5	17,0	24,0	24,0	8,0	GAI12S03
S	G 1/2"	12	630	47,0	30,5	20,0	30,0	24,0	8,0	GAI12S04
S	G 1/4"	14	630	46,0	29,0	17,0	24,0	27,0	10,0	GAI14S02
S	G 3/8"	14	630	46,0	29,0	17,0	24,0	27,0	10,0	GAI14S03
S	G 1/2"	14	630	50,0	32,0	20,0	27,0	27,0	10,0	GAI14S04
S	G 3/4"	14	630	53,0	37,0	20,0	36,0	27,0	10,0	GAI14S06
S	G 1/8"	16	400	40,0	23,0	12,0	27,0	30,0	8,0	GAI16S01
S	G 1/4"	16	400	45,0	27,0	15,0	27,0	30,0	8,0	GAI16S02
S	G 3/8"	16	400	45,0	26,5	17,0	27,0	30,0	8,0	GAI16S03
S	G 1/2"	16	400	50,0	31,5	20,0	30,0	30,0	12,0	GAI16S04
S	G 1/2"	20	400	54,0	32,0	20,0	32,0	36,0	16,0	GAI20S04
S	G 3/4"	20	400	56,0	34,5	20,0	36,0	36,0	16,0	GAI20S06
S	G 1"	20	400	60,0	37,5	24,0	41,0	36,0	16,0	GAI20S08
S	G 1"	25	400	62,0	37,5	24,0	41,0	46,0	20,0	GAI25S08
S	G 1"	30	250	63,0	39,5	24,0	46,0	50,0	25,0	GAI30S08
S	G 1 1/4"	30	250	64,0	40,5	25,0	55,0	50,0	25,0	GAI30S10
S	G 1 1/2"	38	250	74,0	43,5	26,0	60,0	60,0	32,0	GAI38S12

**Gerade Aufschraubverschraubung,
Aufschraubgewinde NPT, leichte + schwere Reihe**
straight female coupling,
female thread NPT, light + heavy duty series

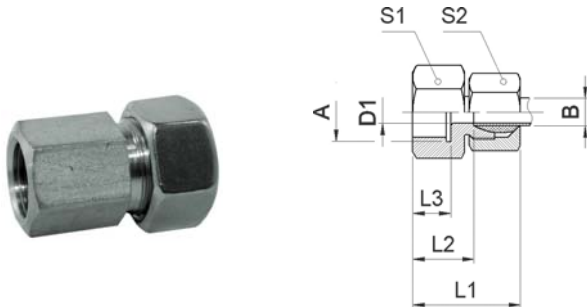

Reihe series	A / Gewinde thread	B / Rohr pipe	PN bar	L1 (mm)	L2 (mm)	L3 (mm)	S1 (mm)	S2 (mm)	D (mm)	Art. Nr. order no.
L	1/8" NPT	6	250	34,0	19,0	12,0	14,0	14,0	4,0	GAI06LN01
L	1/4" NPT	6	250	38,0	25,0	17,0	19,0	14,0	4,0	GAI06LN02
L	1/4" NPT	8	250	39,0	26,0	17,0	19,0	17,0	6,0	GAI08LN02
L	3/8" NPT	8	250	43,0	29,0	17,0	24,0	17,0	6,0	GAI08LN03
L	1/2" NPT	8	250	46,0	32,0	22,0	27,0	17,0	6,0	GAI08LN04
L	1/4" NPT	10	250	39,0	25,5	17,0	19,0	19,0	8,0	GAI10LN02
L	3/8" NPT	10	250	44,0	30,0	18,0	27,0	19,0	8,0	GAI10LN03
L	1/2" NPT	10	250	47,0	34,0	22,0	27,0	19,0	8,0	GAI10LN04
L	1/4" NPT	12	250	40,0	26,0	17,0	19,0	22,0	8,0	GAI12LN02
L	3/8" NPT	12	250	45,0	30,0	18,0	24,0	22,0	10,0	GAI12LN03
L	1/2" NPT	12	250	47,0	32,0	22,0	27,0	22,0	10,0	GAI12LN04
L	1/2" NPT	15	250	48,0	33,0	22,0	27,0	27,0	12,0	GAI15LN04
L	3/4" NPT	15	250	53,0	38,0	25,0	36,0	27,0	12,0	GAI15LN06
L	3/8" NPT	18	160	45,0	28,5	18,0	27,0	32,0	15,0	GAI18LN03
L	1/2" NPT	18	160	49,0	32,5	22,0	27,0	32,0	15,0	GAI18LN04
L	3/4" NPT	18	160	52,0	35,5	25,0	36,0	32,0	15,0	GAI18LN06
L	1/2" NPT	22	160	50,0	33,5	22,0	32,0	36,0	19,0	GAI22LN04
L	3/4" NPT	22	160	56,0	38,5	25,0	36,0	36,0	19,0	GAI22LN06
L	1" NPT	28	100	61,0	44,0	28,0	41,0	41,0	24,0	GAI28LN08
L	1 1/4" NPT	35	100	62,0	40,5	28,0	55,0	50,0	30,0	GAI35LN10
L	1 1/2" NPT	42	100	65,0	44,0	29,0	60,0	60,0	36,0	GAI42LN12

Reihe series	A / Gewinde thread	B / Rohr pipe	PN bar	L1 (mm)	L2 (mm)	L3 (mm)	S1 (mm)	S2 (mm)	D (mm)	Art. Nr. order no.
S	1/4" NPT	6	630	41,0	26,0	17,0	19,0	17,0	4,0	GAI06SN02
S	1/4" NPT	8	630	41,0	24,5	17,0	19,0	19,0	5,0	GAI08SN02
S	3/8" NPT	10	630	47,0	31,0	18,0	22,0	22,0	7,0	GAI10SN03
S	1/2" NPT	10	630	48,0	32,0	22,0	27,0	22,0	7,0	GAI10SN04
S	1/4" NPT	12	630	41,0	26,5	17,0	22,0	24,0	8,0	GAI12SN02
S	3/8" NPT	12	630	46,0	27,5	18,0	24,0	24,0	8,0	GAI12SN03
S	1/2" NPT	12	630	50,0	34,0	22,0	27,0	24,0	8,0	GAI12SN04
S	1/2" NPT	14	630	50,0	33,0	22,0	30,0	27,0	10,0	GAI14SN04
S	1/2" NPT	16	400	50,0	31,5	22,0	27,0	30,0	12,0	GAI16SN04
S	3/4" NPT	20	400	59,0	37,5	25,0	36,0	36,0	16,0	GAI20SN06
S	1" NPT	25	400	65,0	41,0	28,0	41,0	46,0	20,0	GAI25SN08
S	1 1/4" NPT	30	250	70,0	43,5	28,0	55,0	50,0	25,0	GAI30SN10
S	1 1/2" NPT	38	250	74,0	43,0	29,0	60,0	60,0	32,0	GAI38SN12

Manometerverschraubungen Gauge couplings

**Manometer-Aufschraubverschraubung,
Aufschraubgewinde BSPP, leichte Reihe**
manometer female coupling,
female thread BSPP, light duty series

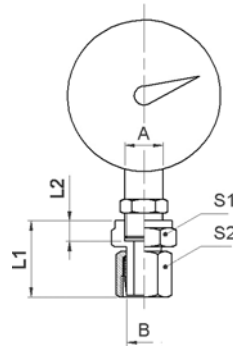

Reihe series	A / Gewinde thread	B / Rohr pipe	PN bar	L1 (mm)	L2 (mm)	S1 (mm)	S2 (mm)	Art. Nr. order no.
L	G 1/4"	6	250	37,0	14,5	19,0	14,0	MAV06L02
L	G 1/2"	6	250	45,0	20,0	27,0	14,0	MAV06L04
L	G 1/4"	8	250	37,0	14,5	19,0	17,0	MAV08L02
L	G 1/2"	8	250	45,0	20,0	27,0	17,0	MAV08L04
L	G 1/4"	10	250	38,0	14,5	19,0	19,0	MAV10L02
L	G 1/2"	10	250	46,0	20,0	27,0	19,0	MAV10L04
L	G 1/4"	12	250	38,0	14,5	19,0	22,0	MAV12L02
L	G 1/2"	12	250	47,0	20,0	27,0	22,0	MAV12L04

**Manometer-Aufschraubverschraubung,
Aufschraubgewinde BSPP, schwere Reihe**
manometer female coupling,
female thread BSPP, heavy duty series

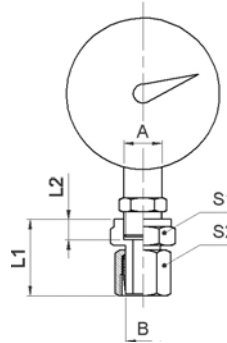

Reihe series	A / Gewinde thread	B / Rohr pipe	PN bar	L1 (mm)	L2 (mm)	S1 (mm)	S2 (mm)	Art. Nr. order no.
S	G 1/2"	6	630	46,0	20,0	27,0	17,0	MAV06S04
S	G 1/2"	8	630	46,0	20,0	27,0	19,0	MAV08S04
S	G 1/2"	10	630	47,0	20,0	27,0	22,0	MAV10S04
S	G 1/2"	12	630	47,0	20,0	27,0	24,0	MAV12S04

Schottverschraubungen
Bulkhead couplings

**Gerade Schottverschraubung,
leichte Reihe**
straight bulkhead coupling,
light duty series

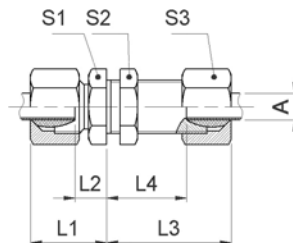

Reihe series	A / Rohr pipe	PN bar	L1 (mm)	L2 (mm)	L3 (mm)	L4 (mm)	S1 (mm)	S2 (mm)	S3 (mm)	Art. Nr. order no.
L	6	250	22,0	7,0	42,0	27,0	17,0	17,0	14,0	SV06L
L	8	250	23,0	8,0	42,0	27,0	19,0	19,0	17,0	SV08L
L	10	250	25,0	10,0	43,0	28,0	22,0	22,0	19,0	SV10L
L	12	250	25,0	10,0	44,0	29,0	24,0	24,0	22,0	SV12L
L	15	250	27,0	12,0	46,0	31,0	27,0	30,0	27,0	SV15L
L	18	160	30,0	13,5	49,0	32,5	32,0	36,0	32,0	SV18L
L	22	160	33,0	16,5	51,0	34,5	36,0	41,0	36,0	SV22L
L	28	100	35,0	18,5	52,0	35,5	41,0	46,0	41,0	SV28L
L	35	100	40,0	18,5	58,0	36,5	50,0	55,0	50,0	SV35L
L	42	100	42,0	19,0	59,0	36,0	60,0	65,0	60,0	SV42L

**Gerade Schottverschraubung,
schwere Reihe**
straight bulkhead coupling,
heavy duty series

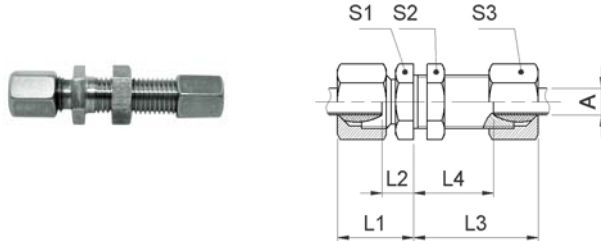

Reihe series	A / Rohr pipe	PN bar	L1 (mm)	L2 (mm)	L3 (mm)	L4 (mm)	S1 (mm)	S2 (mm)	S3 (mm)	Art. Nr. order no.
S	6	630	27,0	12,0	44,0	29,0	19,0	19,0	17,0	SV06S
S	8	630	28,0	13,0	44,0	29,0	22,0	22,0	19,0	SV08S
S	10	630	31,0	14,5	46,0	29,5	22,0	24,0	22,0	SV10S
S	12	630	31,0	14,5	47,0	30,5	24,0	27,0	24,0	SV12S
S	14	630	35,0	16,0	50,0	32,0	27,0	30,0	27,0	SV14S
S	16	400	35,0	16,5	50,0	31,5	32,0	32,0	30,0	SV16S
S	20	400	41,0	19,5	55,0	33,5	36,0	41,0	36,0	SV20S
S	25	400	44,0	20,0	59,0	35,0	46,0	46,0	46,0	SV25S
S	30	250	48,0	21,5	64,0	37,5	46,0	50,0	50,0	SV30S
S	38	250	53,0	22,0	68,0	37,0	55,0	65,0	60,0	SV38S
S	6	630	27,0	12,0	44,0	29,0	19,0	19,0	17,0	SV06S
S	8	630	28,0	13,0	44,0	29,0	22,0	22,0	19,0	SV08S
S	10	630	31,0	14,5	46,0	29,5	22,0	24,0	22,0	SV10S
S	12	630	31,0	14,5	47,0	30,5	24,0	27,0	24,0	SV12S
S	14	630	35,0	16,0	50,0	32,0	27,0	30,0	27,0	SV14S
S	16	400	35,0	16,5	50,0	31,5	32,0	32,0	30,0	SV16S
S	20	400	41,0	19,5	55,0	33,5	36,0	41,0	36,0	SV20S
S	25	400	44,0	20,0	59,0	35,0	46,0	46,0	46,0	SV25S
S	30	250	48,0	21,5	64,0	37,5	46,0	50,0	50,0	SV30S
S	38	250	53,0	22,0	68,0	37,0	55,0	65,0	60,0	SV38S

**Winkel-Schottverschraubung,
leichte + schwere Reihe**
elbow bulkhead coupling,
light + heavy duty series

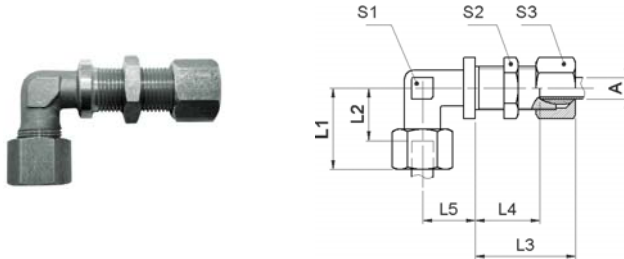

Reihe series	A / Rohr pipe	B / Gewinde thread	PN bar	L1 (mm)	L2 (mm)	L3 (mm)	L4 (mm)	L5 (mm)	S1 (mm)	S2 (mm)	S3 (mm)	Art. Nr. order no.
L	6	M 12x1,5	250	27,0	12,0	42,0	27,0	14,0	12,0	17,0	14,0	WSV06L
L	8	M 14x1,5	250	29,0	14,0	42,0	27,0	17,0	12,0	19,0	17,0	WSV08L
L	10	M 16x1,5	250	30,0	15,0	43,0	28,0	18,0	14,0	22,0	19,0	WSV10L
L	12	M 18x1,5	250	32,0	17,0	44,0	29,0	20,0	17,0	24,0	22,0	WSV12L
L	15	M 22x1,5	250	36,0	21,0	46,0	31,0	23,0	19,0	30,0	27,0	WSV15L
L	18	M 26x1,5	160	40,0	23,5	49,0	32,5	24,0	24,0	36,0	32,0	WSV18L
L	22	M 30x2	160	44,0	30,0	51,0	34,5	30,0	27,0	41,0	36,0	WSV22L
L	28	M 36x2	100	47,0	30,5	52,0	35,5	34,0	36,0	46,0	41,0	WSV28L
L	35	M 45x2	100	56,0	34,5	58,0	36,5	39,0	41,0	55,0	50,0	WSV35L
L	42	M 52x2	100	63,0	40,0	59,0	36,0	43,0	50,0	65,0	60,0	WSV42L

Reihe series	A / Rohr pipe	B / Gewinde thread	PN bar	L1 (mm)	L2 (mm)	L3 (mm)	L4 (mm)	L5 (mm)	S1 (mm)	S2 (mm)	S3 (mm)	Art. Nr. order no.
S	6	M 14x1,5	630	31,0	16,0	44,0	29,0	17,0	12,0	19,0	17,0	WSV06S
S	8	M 16x1,5	630	32,0	17,0	44,0	29,0	18,0	14,0	22,0	19,0	WSV08S
S	10	M 18x1,5	630	34,0	17,5	46,0	29,5	20,0	17,0	24,0	22,0	WSV10S
S	12	M 20x1,5	630	38,0	21,5	47,0	30,5	21,0	17,0	27,0	24,0	WSV12S
S	14	M 22x1,5	630	40,0	22,0	50,0	32,0	23,0	19,0	30,0	27,0	WSV14S
S	16	M 24x1,5	400	43,0	24,5	50,0	31,5	24,0	24,0	32,0	30,0	WSV16S
S	20	M 30x2	400	48,0	26,5	55,0	33,5	30,0	27,0	41,0	36,0	WSV20S
S	25	M 36x2	400	54,0	30,0	59,0	35,0	34,0	36,0	46,0	46,0	WSV25S
S	30	M 42x2	250	62,0	35,5	64,0	37,5	39,0	41,0	50,0	50,0	WSV30S
S	38	M 52x2	250	72,0	41,0	68,0	37,0	43,0	50,0	65,0	60,0	WSV38S

**Einschweißschottverschraubung,
leichte + schwere Reihe**
welding bulkhead coupling,
light + heavy duty series

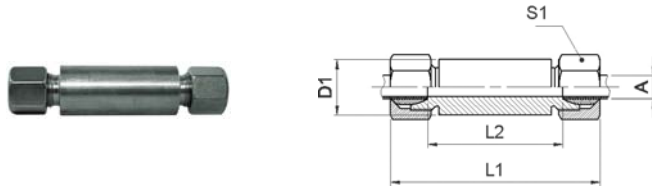

Reihe series	A / Rohr pipe	PN bar	L1 (mm)	L2 (mm)	S1 (mm)	D1 (mm)	Art. Nr. order no
L	6	250	85,0	56,0	14,0	18,0	ESV06L
L	8	250	85,0	56,0	17,0	20,0	ESV08L
L	10	250	87,0	58,0	19,0	22,0	ESV10L
L	12	250	87,0	58,0	22,0	25,0	ESV12L
L	15	250	100,0	70,0	27,0	28,0	ESV15L
L	18	160	101,0	69,0	32,0	32,0	ESV18L
L	22	160	105,0	73,0	36,0	36,0	ESV22L
L	28	100	106,0	73,0	41,0	40,0	ESV28L
L	35	100	114,0	71,0	50,0	50,0	ESV35L
L	42	100	115,0	70,0	60,0	60,0	ESV42L

Reihe series	A / Rohr pipe	PN bar	L1 (mm)	L2 (mm)	S1 (mm)	D1 (mm)	Art. Nr. order no
S	6	630	89,0	60,0	17,0	20,0	ESV06S
S	8	630	89,0	60,0	19,0	22,0	ESV08S
S	10	630	91,0	59,0	22,0	25,0	ESV10S
S	12	630	91,0	59,0	24,0	28,0	ESV12S
S	14	630	107,0	72,0	27,0	30,0	ESV14S
S	16	400	107,0	71,0	30,0	35,0	ESV16S
S	20	400	114,0	71,0	36,0	38,0	ESV20S
S	25	400	120,0	72,0	46,0	45,0	ESV25S
S	30	250	126,0	72,0	50,0	50,0	ESV30S
S	38	250	133,0	72,0	60,0	60,0	ESV38S

Schweißverschraubungen Welding couplings

Anschweißverschraubung,
leichte + schwere Reihe
welding type,
light + heavy duty series

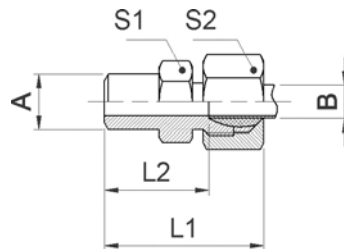

Reihe series	A	B / Rohr pipe	PN bar	L1 (mm)	L2 (mm)	S1 (mm)	S2 (mm)	Art. Nr. order no.
L	10	6	250	29,0	14,0	12,0	14,0	AS06L
L	12	8	250	31,0	16,0	14,0	17,0	AS08L
L	14	10	250	33,0	18,0	17,0	19,0	AS10L
L	16	12	250	33,0	18,0	19,0	22,0	AS12L
L	19	15	250	37,0	22,0	22,0	27,0	AS15L
L	22	18	160	40,0	23,5	27,0	32,0	AS18L
L	27	22	160	45,0	28,5	32,0	36,0	AS22L
L	32	28	100	47,0	30,5	41,0	41,0	AS28L
L	40	35	100	54,0	32,5	46,0	50,0	AS35L
L	46	42	100	58,0	35,0	55,0	60,0	AS42L

Reihe series	A	B / Rohr pipe	PN bar	L1 (mm)	L2 (mm)	S1 (mm)	S2 (mm)	Art. Nr. order no.
S	11	6	630	34,0	19,0	14,0	17,0	AS06S
S	13	8	630	36,0	21,0	17,0	19,0	AS08S
S	15	10	630	39,0	22,5	19,0	22,0	AS10S
S	17	12	630	41,0	24,5	22,0	24,0	AS12S
S	19	14	630	45,0	28,0	24,0	27,0	AS14S
S	21	16	400	45,0	26,5	27,0	30,0	AS16S
S	26	20	400	51,0	29,5	32,0	36,0	AS20S
S	31	25	400	56,0	32,0	41,0	46,0	AS25S
S	36	30	250	62,0	35,5	46,0	50,0	AS30S
S	44	38	250	69,0	38,0	55,0	60,0	AS38S

Reduzierschraubungen Reducer couplings

Gerade Reduzierung,
leichte Reihe
straight reducing coupling,
light duty series

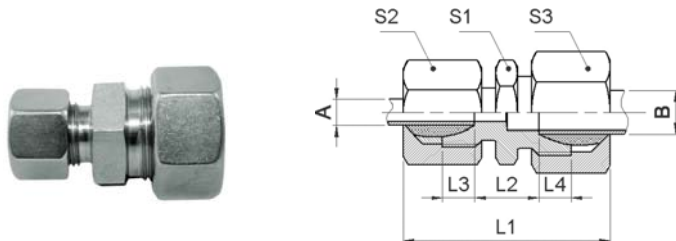

Reihe series	A / Rohr pipe	B / Rohr pipe	PN bar	L1 (mm)	L2 (mm)	L3 (mm)	L4 (mm)	S1 (mm)	S2 (mm)	S3 (mm)	Art. Nr. order no.
L	8	6	250	40,0	11,0	7,0	7,0	14,0	17,0	14,0	GR0806L
L	10	6	250	41,0	12,0	7,0	7,0	17,0	19,0	14,0	GR1006L
L	10	8	250	41,0	13,0	7,0	7,0	17,0	19,0	17,0	GR1008L
L	12	6	250	42,0	13,0	7,0	7,0	19,0	22,0	14,0	GR1206L
L	12	8	250	42,0	14,0	7,0	7,0	19,0	22,0	17,0	GR1208L
L	12	10	250	43,0	14,0	7,0	7,0	19,0	22,0	19,0	GR1210L
L	15	6	250	43,5	16,0	7,0	7,0	24,0	27,0	14,0	GR1506L
L	15	8	250	43,5	15,0	7,0	7,0	24,0	27,0	17,0	GR1508L
L	15	10	250	44,5	15,0	7,0	7,0	22,0	27,0	19,0	GR1510L
L	15	12	250	45,0	15,5	7,0	7,5	22,0	27,0	22,0	GR1512L
L	18	8	160	45,0	17,0	7,0	7,0	27,0	32,0	17,0	GR1808L
L	18	10	160	46,0	16,5	7,5	7,0	27,0	32,0	19,0	GR1810L
L	18	12	160	47,0	17,5	7,5	7,0	27,0	32,0	22,0	GR1812L
L	18	15	160	47,5	16,5	7,5	7,0	27,0	32,0	27,0	GR1815L
L	22	10	160	49,5	17,5	7,5	7,0	32,0	36,0	19,0	GR2210L
L	22	12	160	48,0	17,0	7,5	7,5	32,0	36,0	22,0	GR2212L
L	22	15	160	51,0	21,5	7,5	7,0	32,0	36,0	27,0	GR2215L
L	22	18	160	54,0	21,0	7,5	7,5	32,0	36,0	32,0	GR2218L
L	28	10	100	52,0	21,0	7,5	7,0	41,0	41,0	19,0	GR2810L
L	28	12	100	51,0	21,0	7,5	7,0	41,0	41,0	22,0	GR2812L
L	28	15	100	54,0	21,5	7,5	7,0	41,0	41,0	27,0	GR2815L
L	28	18	100	55,0	19,0	7,5	7,5	41,0	41,0	32,0	GR2818L
L	28	22	100	54,0	21,0	7,5	7,5	41,0	41,0	36,0	GR2822L
L	35	15	100	58,0	22,5	11,0	7,0	46,0	50,0	27,0	GR3515L
L	35	18	100	58,0	21,5	11,0	7,5	46,0	50,0	32,0	GR3518L
L	35	22	100	60,0	22,5	11,0	7,5	46,0	50,0	36,0	GR3522L
L	35	28	100	59,0	21,0	10,5	7,5	46,0	50,0	41,0	GR3528L
L	42	15	100	60,0	23,0	10,5	7,0	55,0	60,0	27,0	GR4215L
L	42	18	100	60,5	23,0	10,5	7,5	55,0	60,0	32,0	GR4218L
L	42	22	100	61,5	23,0	10,5	7,5	55,0	60,0	36,0	GR4222L
L	42	28	100	61,5	23,0	10,5	7,5	55,0	60,0	41,0	GR4228L
L	42	35	100	66,5	21,5	10,5	10,5	55,0	60,0	50,0	GR4235L

**Gerade Reduzierung,
schwere Reihe**
straight reducing coupling,
heavy duty series

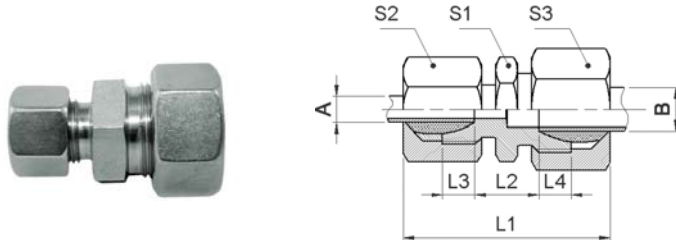

Reihe series	A / Rohr pipe	B / Rohr pipe	PN bar	L1 (mm)	L2 (mm)	L3 (mm)	L4 (mm)	S1 (mm)	S2 (mm)	S3 (mm)	Art. Nr. order no.
S	8	6	630	47,0	16,5	7,0	7,0	17,0	19,0	17,0	GR0806S
S	10	6	630	48,0	17,5	7,5	7,0	19,0	22,0	17,0	GR1006S
S	10	8	630	48,0	17,5	7,5	7,0	19,0	22,0	19,0	GR1008S
S	12	6	630	50,0	19,5	7,5	7,0	22,0	24,0	17,0	GR1206S
S	12	8	630	50,0	20,0	7,5	7,0	22,0	24,0	19,0	GR1208S
S	12	10	630	51,0	19,5	7,5	7,5	22,0	24,0	22,0	GR1210S
S	14	8	630	53,0	20,0	8,0	7,0	24,0	27,0	19,0	GR1408S
S	14	10	630	54,0	20,5	8,0	7,5	24,0	27,0	22,0	GR1410S
S	14	12	630	54,0	20,5	8,0	7,5	24,0	27,0	24,0	GR1412S
S	16	6	400	53,0	20,0	8,5	7,0	27,0	30,0	17,0	GR1606S
S	16	8	400	53,5	20,5	8,5	7,0	27,0	30,0	19,0	GR1608S
S	16	10	400	54,5	20,0	8,5	7,5	27,0	30,0	22,0	GR1610S
S	16	12	400	54,5	20,0	8,5	7,5	27,0	30,0	24,0	GR1612S
S	16	14	400	57,0	21,5	8,5	8,0	27,0	30,0	27,0	GR1614S
S	20	10	400	59,5	22,0	10,5	7,5	32,0	36,0	22,0	GR2010S
S	20	12	400	59,5	21,0	10,5	7,5	32,0	36,0	24,0	GR2012S
S	20	14	400	62,5	22,0	10,5	8,0	32,0	36,0	27,0	GR2014S
S	20	16	400	62,5	23,0	10,5	8,5	32,0	36,0	30,0	GR2016S
S	25	10	400	61,5	23,0	12,0	7,5	41,0	46,0	22,0	GR2510S
S	25	12	400	61,5	23,0	12,0	7,5	41,0	46,0	24,0	GR2512S
S	25	14	400	64,5	26,0	12,0	8,0	41,0	46,0	27,0	GR2514S
S	25	16	400	64,5	22,5	12,0	8,5	41,0	46,0	30,0	GR2516S
S	25	20	400	71,5	24,5	12,0	10,5	41,0	46,0	36,0	GR2520S
S	30	12	250	67,0	23,5	13,5	7,5	46,0	50,0	24,0	GR3012S
S	30	14	250	68,0	23,5	13,5	8,0	46,0	50,0	27,0	GR3014S
S	30	16	250	72,0	26,5	13,5	8,5	46,0	50,0	30,0	GR3016S
S	30	20	250	74,0	26,0	13,5	10,5	46,0	50,0	36,0	GR3020S
S	30	25	250	77,0	26,5	13,5	13,5	46,0	50,0	46,0	GR3025S
S	38	16	250	75,0	25,5	16,0	8,5	55,0	60,0	30,0	GR3816S
S	38	20	250	77,0	26,0	16,0	10,5	55,0	60,0	36,0	GR3820S
S	38	25	250	84,0	31,5	16,0	12,0	55,0	60,0	46,0	GR3825S
S	38	30	250	87,0	29,5	16,0	13,5	55,0	60,0	50,0	GR3830S

**T-Reduzierung,
leichte Reihe**
T-reducer coupling,
light duty series

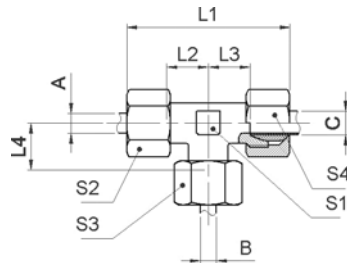

Reihe series	A / Rohr pipe	B / Rohr pipe	C / Rohr pipe	PN bar	L1 (mm)	L2 (mm)	L3 (mm)	L4 (mm)	S1 (mm)	S2 (mm)	S3 (mm)	S4 (mm)	Art. Nr. order no.
L	6	10	6	250	58,0	14,0	14,0	15,0	14,0	14,0	19,0	14,0	TR061006L3
L	8	6	8	250	58,0	14,0	14,0	15,5	12,0	17,0	14,0	17,0	TR080608L3
L	8	8	12	250	65,0	17,5	17,0	18,5	17,0	17,0	17,0	22,0	TR080812L3
L	8	12	8	250	63,0	17,0	17,0	17,5	17,0	17,0	22,0	17,0	TR081208L3
L	10	6	6	250	62,0	15,5	14,0	14,5	14,0	19,0	14,0	14,0	TR100606L3
L	10	6	10	250	59,0	15,5	15,5	15,5	14,0	19,0	14,0	19,0	TR100610L3
L	10	8	10	250	60,0	15,0	15,0	15,5	14,0	19,0	17,0	19,0	TR100810L3
L	10	10	6	250	61,0	15,0	14,0	15,0	14,0	19,0	14,0	19,0	TR101006L3
L	10	12	10	250	60,0	15,0	18,0	16,5	14,0	19,0	22,0	19,0	TR101210L3
L	10	15	10	250	71,0	21,0	21,0	21,0	19,0	19,0	27,0	19,0	TR101510L3
L	12	6	12	250	64,0	17,0	17,0	17,5	17,0	22,0	14,0	22,0	TR120612L3
L	12	8	12	250	64,0	17,0	17,0	18,0	17,0	22,0	17,0	22,0	TR120812L3
L	12	10	10	250	64,0	17,5	17,5	18,0	17,0	22,0	19,0	19,0	TR121010L3
L	12	10	12	250	64,0	17,0	17,0	17,5	17,0	22,0	19,0	22,0	TR121012L3
L	12	12	8	250	65,0	16,5	18,5	17,5	17,0	22,0	22,0	17,0	TR121208L3
L	12	12	10	250	64,0	17,0	18,0	16,5	17,0	22,0	22,0	19,0	TR121210L3
L	15	10	10	250	71,0	21,5	21,5	21,5	19,0	27,0	19,0	19,0	TR151010L3
L	15	10	15	250	72,0	21,0	21,0	21,5	19,0	27,0	19,0	27,0	TR151015L3
L	15	12	12	250	73,0	21,0	21,5	21,5	19,0	27,0	22,0	22,0	TR151212L3
L	15	12	15	250	72,0	20,5	20,5	21,0	19,0	27,0	22,0	27,0	TR151215L3
L	15	15	10	250	72,0	21,0	21,0	21,0	19,0	27,0	27,0	19,0	TR151510L3
L	18	10	18	160	81,0	23,5	23,5	26,0	24,0	32,0	19,0	32,0	TR181018L3
L	18	12	18	160	81,0	23,5	23,5	25,5	24,0	32,0	22,0	32,0	TR181218L3
L	18	15	18	160	80,0	23,5	23,5	23,5	24,0	32,0	27,0	32,0	TR181518L3
L	18	18	10	160	79,0	23,5	24,0	23,5	24,0	32,0	32,0	19,0	TR181810L3
L	18	18	12	160	77,0	23,5	22,5	23,5	24,0	32,0	32,0	22,0	TR181812L3
L	18	22	18	160	88,0	31,5	31,5	27,0	27,0	32,0	36,0	32,0	TR182218L3
L	22	12	22	160	89,0	27,5	25,0	28,0	27,0	36,0	22,0	36,0	TR221222L3
L	22	15	15	160	87,0	28,0	26,5	26,5	27,0	36,0	27,0	27,0	TR221515L3
L	22	15	22	160	89,0	27,5	27,5	28,0	27,0	36,0	27,0	36,0	TR221522L3
L	22	18	18	160	89,0	27,0	27,0	28,0	27,0	36,0	32,0	32,0	TR221818L3
L	22	18	22	160	88,0	27,5	27,5	27,5	27,0	36,0	32,0	36,0	TR221822L3
L	22	22	18	160	90,0	27,5	30,0	28,0	27,0	36,0	36,0	32,0	TR222218L3
L	28	18	28	100	95,0	30,5	30,5	30,5	36,0	41,0	32,0	41,0	TR281828L3
L	28	22	22	100	95,0	30,5	30,5	31,0	36,0	41,0	36,0	36,0	TR282222L3
L	28	22	28	100	94,0	30,5	30,5	27,5	36,0	41,0	36,0	41,0	TR282228L3
L	28	28	22	100	94,0	30,5	30,5	30,5	36,0	41,0	41,0	36,0	TR282822L3
L	28	35	28	100	107,0	36,5	36,5	36,0	41,0	41,0	50,0	41,0	TR283528L3
L	35	22	35	100	108,0	34,0	34,0	32,5	41,0	41,0	36,0	41,0	TR352235L3
L	35	28	28	100	108,0	34,0	36,5	36,5	41,0	50,0	41,0	41,0	TR352828L3

**T-Reduzierung,
leichte + schwere Reihe**
T-reducer coupling,
light + heavy duty series

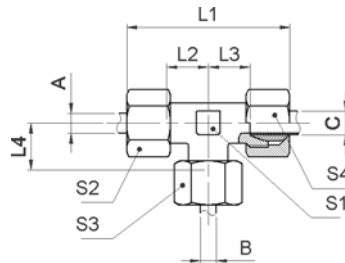

Reihe series	A / Rohr pipe	B / Rohr pipe	C / Rohr pipe	PN bar	L1 (mm)	L2 (mm)	L3 (mm)	L4 (mm)	S1 (mm)	S2 (mm)	S3 (mm)	S4 (mm)	Art. Nr. order no.
L	35	28	35	100	110,0	34,0	34,0	32,5	41,0	50,0	41,0	50,0	TR352835L3
L	42	22	42	100	123,0	40,0	40,0	43,5	50,0	60,0	36,0	60,0	TR422242L3
L	42	28	42	100	123,0	40,0	40,0	43,5	50,0	60,0	41,0	60,0	TR422842L3

Reihe series	A / Rohr pipe	B / Rohr pipe	C / Rohr pipe	PN bar	L1 (mm)	L2 (mm)	L3 (mm)	L4 (mm)	S1 (mm)	S2 (mm)	S3 (mm)	S4 (mm)	Art. Nr. order no.
S	10	12	10	630	75,0	21,5	21,5	22,0	17,0	22,0	24,0	22,0	TR101210S3
S	10	12	12	630	73,0	22,0	21,5	22,5	17,0	22,0	24,0	24,0	TR101212S3
S	12	6	12	630	77,0	21,5	21,5	21,5	20,0	24,0	17,0	24,0	TR120612S3
S	12	8	12	630	76,0	22,0	22,0	22,5	17,0	24,0	19,0	24,0	TR120812S3
S	12	10	12	630	76,0	22,0	22,0	22,5	17,0	24,0	22,0	24,0	TR121012S3
S	12	16	12	400	77,0	22,0	22,0	24,5	24,0	24,0	30,0	24,0	TR121612S3
S	14	10	14	630	78,0	22,0	22,0	21,0	19,0	27,0	22,0	27,0	TR141014S3
S	14	12	14	630	78,0	22,0	22,0	21,0	19,0	27,0	24,0	27,0	TR141214S3
S	16	10	16	400	84,0	24,5	24,5	24,0	24,0	30,0	22,0	30,0	TR161016S3
S	16	12	12	400	81,0	24,5	23,5	22,5	24,0	30,0	24,0	24,0	TR161212S3
S	16	12	16	400	85,0	24,5	24,5	25,0	24,0	30,0	24,0	30,0	TR161216S3
S	16	14	16	400	86,0	24,5	24,5	25,5	24,0	30,0	27,0	30,0	TR161416S3
S	16	16	12	400	81,0	25,0	22,5	22,0	24,0	30,0	30,0	24,0	TR161612S3
S	16	16	20	400	95,0	30,5	31,5	26,5	27,0	30,0	30,0	36,0	TR161620S3
S	16	16	25	400	106,0	29,5	30,5	30,5	36,0	30,0	30,0	46,0	TR161625S3
S	16	20	16	400	92,0	28,5	28,5	26,5	27,0	30,0	36,0	30,0	TR162016S3
S	16	25	16	400	102,0	33,0	33,0	30,0	36,0	30,0	46,0	30,0	TR162516S3
S	20	8	20	400	94,0	26,5	26,5	29,5	27,0	36,0	19,0	36,0	TR200820S3
S	20	10	20	400	96,0	27,5	27,5	31,0	27,0	36,0	22,0	36,0	TR201020S3
S	20	12	20	400	95,0	26,5	26,5	27,5	27,0	36,0	24,0	36,0	TR201220S3
S	20	14	20	400	95,0	26,5	26,5	26,5	27,0	36,0	27,0	36,0	TR201420S3
S	20	16	20	400	95,0	26,5	26,5	26,5	27,0	36,0	30,0	36,0	TR201620S3
S	20	25	20	400	105,0	31,5	31,5	30,5	36,0	36,0	46,0	36,0	TR202520S3
S	25	10	25	400	108,0	30,0	30,0	30,0	36,0	46,0	22,0	46,0	TR251025S3
S	25	12	25	400	106,0	30,0	30,0	27,5	36,0	46,0	24,0	46,0	TR251225S3
S	25	14	25	400	106,0	30,0	30,0	27,5	36,0	46,0	27,0	46,0	TR251425S3
S	25	16	25	400	106,0	30,0	30,0	27,5	36,0	46,0	30,0	46,0	TR251625S3
S	25	20	25	400	106,0	30,0	30,0	25,5	36,0	46,0	36,0	46,0	TR252025S3
S	25	25	16	400	106,0	30,5	30,5	29,5	36,0	46,0	46,0	30,0	TR252516S3
S	30	16	30	250	123,0	36,5	37,5	37,5	41,0	50,0	30,0	46,0	TR301630S3
S	30	20	30	250	123,0	36,5	37,5	37,5	41,0	50,0	36,0	46,0	TR302030S3
S	30	25	25	250	123,0	36,5	37,5	37,5	41,0	50,0	46,0	46,0	TR302525S3

**T-Reduzierung,
schwere Reihe**
T-reducer coupling,
heavy duty series

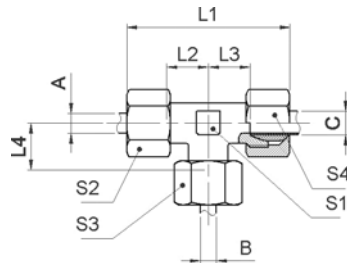

Reihe series	A / Rohr pipe	B / Rohr pipe	C / Rohr pipe	PN bar	L1 (mm)	L2 (mm)	L3 (mm)	L4 (mm)	S1 (mm)	S2 (mm)	S3 (mm)	S4 (mm)	Art. Nr. order no.
S	30	25	30	250	123,0	36,5	37,5	37,5	41,0	50,0	46,0	46,0	TR302530S3
S	38	20	38	250	141,0	41,0	41,0	43,0	50,0	60,0	36,0	60,0	TR382038S3
S	38	25	38	250	141,0	41,0	41,0	43,0	50,0	60,0	46,0	60,0	TR382538S3
S	38	30	30	250	141,0	41,0	41,0	43,0	50,0	60,0	50,0	50,0	TR383030S3
S	38	30	38	250	141,0	41,0	41,0	43,0	50,0	60,0	50,0	60,0	TR383038S3
S	38	38	30	250	141,0	41,5	43,5	41,0	50,0	60,0	60,0	50,0	TR383830S3

Einstellbare-Verschraubungen mit Schaft
Male stud couplings with union adjustable

Gerade Einschraubverschraubung mit Schaft,
Einschraubgewinde BSPP mit Dichtkante Form B, leichte Reihe
straight male stud coupling,
union adjustable, male thread BSPP, with sealing edge form B, light duty series

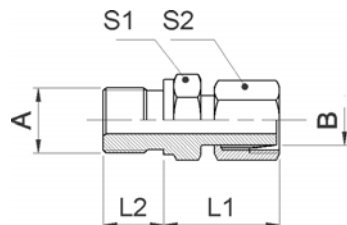

Reihe series	A / Gewinde thread	B / Rohr pipe	PN bar	L1 (mm)	L2 (mm)	S1 (mm)	S2 (mm)	Art. Nr. order no.
L	G 1/8"	6	250	24,5	8,0	14,0	14,0	EVGE06L01
L	G 1/4"	6	250	25,0	12,0	19,0	14,0	EVGE06L02
L	G 1/4"	8	250	29,5	12,0	19,0	17,0	EVGE08L02
L	G 3/8"	8	250	29,0	12,0	22,0	17,0	EVGE08L03
L	G 1/4"	10	250	27,5	12,0	19,0	19,0	EVGE10L02
L	G 3/8"	10	250	32,0	12,0	22,0	19,0	EVGE10L03
L	G 1/2"	10	250	32,5	14,0	27,0	19,0	EVGE10L04
L	G 1/4"	12	250	29,0	12,0	19,0	22,0	EVGE12L02
L	G 3/8"	12	250	34,0	12,0	22,0	22,0	EVGE12L03
L	G 1/2"	12	250	34,0	14,0	27,0	22,0	EVGE12L04
L	G 3/8"	15	250	32,5	12,0	22,0	27,0	EVGE15L03
L	G 1/2"	15	250	32,0	14,0	27,0	27,0	EVGE15L04

**Gerade Einschraubverschraubung mit Schaft,
Einschraubgewinde BSPP mit Dichtkante Form B, leichte + schwere Reihe**
straight male stud coupling,
union adjustable, male thread BSPP, with sealing edge form B, light + heavy duty series

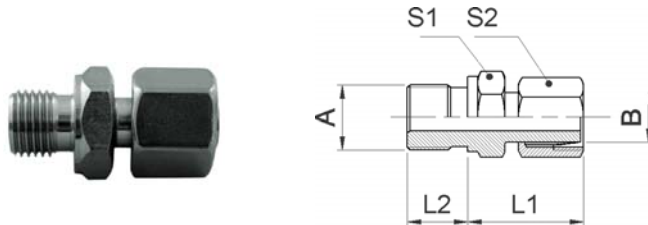

Reihe series	A / Gewinde thread	B / Rohr pipe	PN bar	L1 (mm)	L2 (mm)	S1 (mm)	S2 (mm)	Art. Nr. order no.
L	G 1/2"	18	160	32,5	14,0	27,0	32,0	EVGE18L04
L	G 3/4"	18	160	32,5	16,0	32,0	32,0	EVGE18L06
L	G 1/2"	22	160	32,5	14,0	27,0	36,0	EVGE22L04
L	G 3/4"	22	160	32,5	16,0	32,0	36,0	EVGE22L06
L	G 3/4"	28	100	34,5	16,0	32,0	41,0	EVGE28L06
L	G 1"	28	100	35,0	18,0	41,0	41,0	EVGE28L08
L	G 1 1/4"	35	100	43,0	20,0	50,0	50,0	EVGE35L10
L	G 1 1/2"	42	100	46,0	22,0	55,0	60,0	EVGE42L12

Reihe series	A / Gewinde thread	B / Rohr pipe	PN bar	L1 (mm)	L2 (mm)	S1 (mm)	S2 (mm)	Art. Nr. order no.
S	G 1/4"	6	630	27,0	12,0	19,0	17,0	EVGE06S02
S	G 3/8"	6	630	27,0	12,0	22,0	17,0	EVGE06S03
S	G 1/4"	8	630	29,0	12,0	19,0	19,0	EVGE08S02
S	G 3/8"	8	630	29,5	12,0	22,0	19,0	EVGE08S03
S	G 1/4"	10	630	32,0	12,0	19,0	22,0	EVGE10S02
S	G 3/8"	10	630	32,0	12,0	22,0	22,0	EVGE10S03
S	G 1/2"	10	630	33,0	14,0	27,0	22,0	EVGE10S04
S	G 1/4"	12	630	33,0	12,0	19,0	24,0	EVGE12S02
S	G 3/8"	12	630	34,0	12,0	22,0	24,0	EVGE12S03
S	G 1/2"	12	630	35,0	14,0	27,0	24,0	EVGE12S04
S	G 1/2"	14	630	36,5	14,0	27,0	27,0	EVGE14S04
S	G 1/2"	16	400	40,0	14,0	27,0	30,0	EVGE16S04
S	G 3/4"	16	400	33,0	16,0	32,0	30,0	EVGE16S06
S	G 1/2"	20	400	41,0	14,0	27,0	36,0	EVGE20S04
S	G 3/4"	20	400	43,0	16,0	32,0	36,0	EVGE20S06
S	G 3/4"	25	400	47,5	16,0	32,0	46,0	EVGE25S06
S	G 1"	25	400	48,0	18,0	41,0	46,0	EVGE25S08
S	G 1 1/4"	30	250	51,0	20,0	50,0	50,0	EVGE30S10
S	G 1 1/2"	38	250	58,0	22,0	55,0	60,0	EVGE38S12

Gerade Einschraubverschraubung mit Schaft,
Gewinde BSPP mit Dichtkante Form E , leichte + schwere Reihe
straight male stud coupling,
union adjustable, male thread BSPP with sealing edge form E, light + heavy duty series

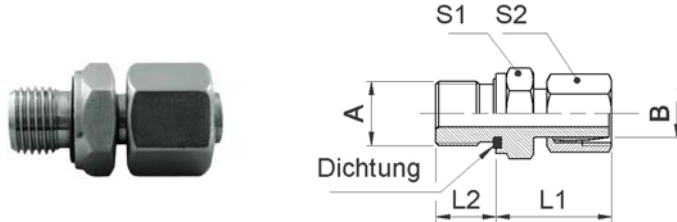

Reihe series	A / Gewinde thread	B / Rohr pipe	PN bar	L1 (mm)	L2 (mm)	S1 (mm)	S2 (mm)	Art. Nr. order no.
L	G1/8"	6	250	24,5	8,0	14,0	14,0	EVGE06LED01
L	G1/4"	6	250	25,0	12,0	19,0	14,0	EVGE06LED02
L	G1/4"	8	250	29,5	12,0	19,0	17,0	EVGE08LED02
L	G3/8"	8	250	29,0	12,0	22,0	17,0	EVGE08LED03
L	G1/4"	10	250	27,5	12,0	19,0	19,0	EVGE10LED02
L	G3/8"	10	250	32,0	12,0	22,0	19,0	EVGE10LED03
L	G1/2"	10	250	32,5	14,0	27,0	19,0	EVGE10LED04
L	G1/4"	12	250	29,0	12,0	19,0	22,0	EVGE12LED02
L	G3/8"	12	250	34,0	12,0	22,0	22,0	EVGE12LED03
L	G1/2"	12	250	34,0	14,0	27,0	22,0	EVGE12LED04
L	G3/8"	15	250	32,5	12,0	22,0	27,0	EVGE15LED03
L	G1/2"	15	250	32,0	14,0	27,0	27,0	EVGE15LED04
L	G1/2"	18	160	32,5	14,0	27,0	32,0	EVGE18LED04
L	G3/4"	18	160	32,5	16,0	32,0	32,0	EVGE18LED06
L	G1/2"	22	160	32,5	14,0	27,0	36,0	EVGE22LED04
L	G3/4"	22	160	32,5	16,0	32,0	36,0	EVGE22LED06
L	G3/4"	28	100	34,5	16,0	32,0	41,0	EVGE28LED06
L	G1"	28	100	35,0	18,0	41,0	41,0	EVGE28LED08
L	G1 1/4"	35	100	43,0	20,0	50,0	50,0	EVGE35LED10
L	G1 1/2"	42	100	46,0	22,0	55,0	60,0	EVGE42LED12

Reihe series	A / Gewinde thread	B / Rohr pipe	PN bar	L1 (mm)	L2 (mm)	S1 (mm)	S2 (mm)	Art. Nr. order no.
S	G1/4"	6	630	27,0	12,0	19,0	17,0	EVGE06SED02
S	G3/8"	6	630	27,0	12,0	22,0	17,0	EVGE06SED03
S	G1/4"	8	630	29,0	12,0	19,0	19,0	EVGE08SED02
S	G3/8"	8	630	29,5	12,0	22,0	19,0	EVGE08SED03
S	G1/4"	10	630	32,0	12,0	19,0	22,0	EVGE10SED02
S	G3/8"	10	630	32,0	12,0	22,0	22,0	EVGE10SED03
S	G1/2"	10	630	33,0	14,0	27,0	22,0	EVGE10SED04
S	G1/4"	12	630	33,0	12,0	19,0	24,0	EVGE12SED02
S	G3/8"	12	630	34,0	12,0	22,0	24,0	EVGE12SED03
S	G1/2"	12	630	35,0	14,0	27,0	24,0	EVGE12SED04
S	G1/2"	14	630	36,5	14,0	27,0	27,0	EVGE14SED04
S	G1/2"	16	400	40,0	14,0	27,0	30,0	EVGE16SED04
S	G3/4"	16	400	33,0	16,0	32,0	30,0	EVGE16SED06
S	G1/2"	20	400	41,0	14,0	27,0	36,0	EVGE20SED04
S	G3/4"	20	400	43,0	16,0	32,0	36,0	EVGE20SED06
S	G3/4"	25	400	47,5	16,0	32,0	46,0	EVGE25SED06

**Gerade Einschraubverschraubung mit Schaft,
Gewinde BSPP mit Dichtkante Form E , schwere Reihe**
straight male stud coupling,
union adjustable, male thread BSPP with sealing edge form E, heavy duty series

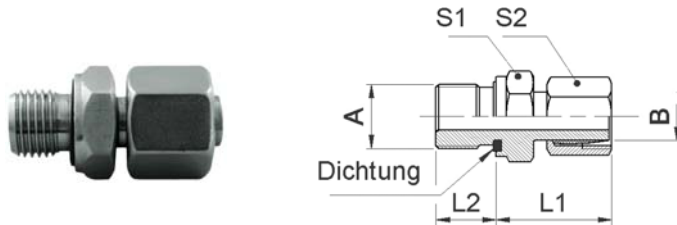

Reihe series	A / Gewinde thread	B / Rohr pipe	PN bar	L1 (mm)	L2 (mm)	S1 (mm)	S2 (mm)	Art. Nr. order no.
S	G1"	25	400	48,0	18,0	41,0	46,0	EVGE25SED08
S	G1 1/4"	30	250	51,0	20,0	50,0	50,0	EVGE30SED10
S	G1 1/2"	38	250	58,0	22,0	55,0	60,0	EVGE38SED12

**Gerade Einschraubverschraubung mit Schaft,
Gewinde metrisch mit Dichtkante Form B, leichte Reihe**
straight male stud coupling,
union adjustable, male thread metric, with sealing edge form B, light duty series



Reihe series	A / Gewinde thread	B / Rohr pipe	PN bar	L1 (mm)	L2 (mm)	S1 (mm)	S2 (mm)	Art. Nr. order no.
L	M10x1,0	6	250	24,5	8,0	14,0	14,0	EVGE06LM10
L	M12x1,5	8	250	26,5	12,0	17,0	17,0	EVGE08LM12
L	M14x1,5	10	250	27,5	12,0	19,0	19,0	EVGE10LM14
L	M16x1,5	12	250	29,5	12,0	22,0	22,0	EVGE12LM16
L	M18x1,5	15	250	31,5	12,0	24,0	27,0	EVGE15LM18
L	M22x1,5	18	160	32,0	14,0	27,0	32,0	EVGE18LM22
L	M26x1,5	22	160	32,5	16,0	32,0	41,0	EVGE22LM26
L	M33x2,0	28	100	35,0	18,0	41,0	41,0	EVGE28LM33
L	M42x2,0	35	100	42,5	20,0	50,0	50,0	EVGE35LM42
L	M48x2,0	42	100	46,5	22,0	55,0	60,0	EVGE42LM48

**Gerade Einschraubverschraubung mit Schaft,
Gewinde metrisch mit Dichtkante Form B, schwere Reihe**
straight male stud coupling,
union adjustable, male thread metric, with sealing edge form B, heavy duty series

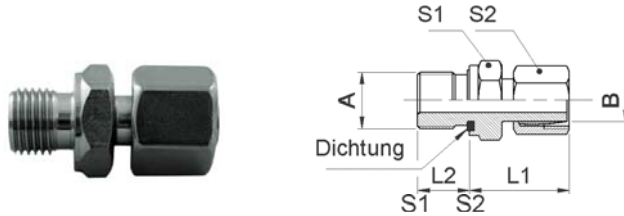

Reihe series	A / Gewinde thread	B / Rohr pipe	PN bar	L1 (mm)	L2 (mm)	S1 (mm)	S2 (mm)	Art. Nr. order no.
S	M12x1,5	6	630	27,0	12,0	17,0	17,0	EVGE06SM12
S	M14x1,5	8	630	29,5	12,0	19,0	19,0	EVGE08SM14
S	M16x1,5	10	630	32,0	12,0	22,0	22,0	EVGE10SM16
S	M18x1,5	12	630	34,0	12,0	24,0	22,0	EVGE12SM18
S	M20x1,5	14	630	36,0	14,0	27,0	27,0	EVGE14SM20
S	M22x1,5	16	400	37,0	14,0	27,0	30,0	EVGE16SM22
S	M27x2,0	20	400	43,0	16,0	32,0	36,0	EVGE20SM27
S	M33x2,0	25	400	49,0	18,0	41,0	46,0	EVGE25SM33
S	M42x2,0	30	250	51,0	20,0	50,0	50,0	EVGE30SM42
S	M48x2,0	38	250	60,0	22,0	55,0	60,0	EVGE38SM48

**Gerade Einschraubverschraubung mit Schaft,
Gewinde metrisch mit Dichtkante Form E, schwere Reihe**
straight male stud coupling,
union adjustable, male thread metric, with sealing edge form E, heavy duty series

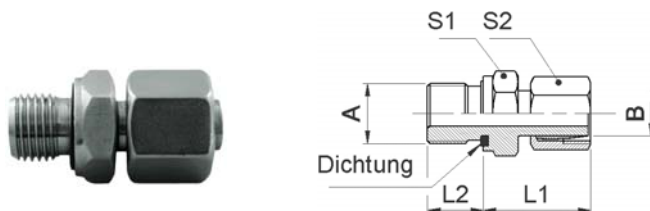

Reihe series	A / Gewinde thread	B / Rohr pipe	PN bar	L1 (mm)	L2 (mm)	S1 (mm)	S2 (mm)	Art. Nr. order no.
L	M10x1,0	6	250	24,5	8,0	14,0	14,0	EVGE06LMED10
L	M12x1,5	8	250	26,5	12,0	17,0	17,0	EVGE08LMED12
L	M14x1,5	10	250	27,5	12,0	19,0	19,0	EVGE10LMED14
L	M16x1,5	12	250	29,5	12,0	22,0	22,0	EVGE12LMED16
L	M18x1,5	15	250	31,5	12,0	24,0	27,0	EVGE15LMED18
L	M22x1,5	18	160	32,0	14,0	27,0	32,0	EVGE18LMED22
L	M26x1,5	22	160	32,5	16,0	32,0	41,0	EVGE22LMED26
L	M33x2,0	28	100	35,0	18,0	41,0	41,0	EVGE28LMED33
L	M42x2,0	35	100	42,5	20,0	50,0	50,0	EVGE35LMED42
L	M48x2,0	42	100	46,5	22,0	55,0	60,0	EVGE42LMED48

**Gerade Einschraubverschraubung mit Schaft,
Gewinde metrisch mit Dichtkante Form E, schwere Reihe**
straight male stud coupling,
union adjustable, male thread metric, with sealing edge form E, heavy duty series

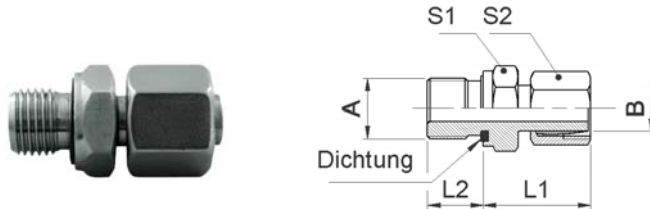

Reihe series	A / Gewinde thread	B / Rohr pipe	PN bar	L1 (mm)	L2 (mm)	S1 (mm)	S2 (mm)	Art. Nr. order no.
S	M12x1,5	6	630	27,0	12,0	17,0	17,0	EVGE06SMED12
S	M14x1,5	8	630	29,5	12,0	19,0	19,0	EVGE08SMED14
S	M16x1,5	10	630	32,0	12,0	22,0	22,0	EVGE10SMED16
S	M18x1,5	12	630	34,0	12,0	24,0	22,0	EVGE12SMED18
S	M20x1,5	14	630	36,0	14,0	27,0	27,0	EVGE14SMED20
S	M22x1,5	16	400	37,0	14,0	27,0	30,0	EVGE16SMED22
S	M27x2,0	20	400	43,0	16,0	32,0	36,0	EVGE20SMED27
S	M33x2,0	25	400	49,0	18,0	41,0	46,0	EVGE25SMED33
S	M42x2,0	30	250	51,0	20,0	50,0	50,0	EVGE30SMED42
S	M48x2,0	38	250	60,0	22,0	55,0	60,0	EVGE38SMED48

**Gerade Einschraubverschraubung mit Schaft,
Einschraubgewinde NPT, leichte Reihe**
straight male stud coupling,
union adjustable, male thread NPT, light duty series

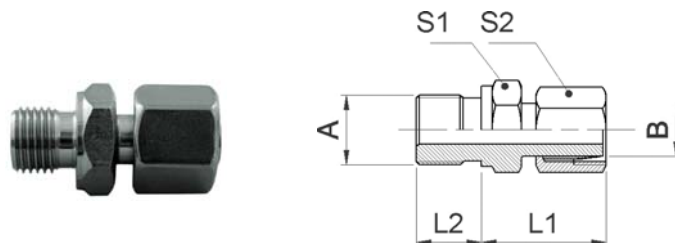

Reihe series	A / Gewinde thread	B / Rohr pipe	PN bar	L1 (mm)	L2 (mm)	S1 (mm)	S2 (mm)	Art. Nr. order no.
L	1/8" NPT	6	250	24,5	10,0	14,0	14,0	EVGE06LN01
L	1/4" NPT	8	250	41,0	14,5	19,0	17,0	EVGE08LN02
L	1/4" NPT	10	250	42,5	14,5	17,0	19,0	EVGE10LN02
L	3/8" NPT	12	250	47,0	14,5	19,0	22,0	EVGE12LN03
L	1/2" NPT	15	250	50,0	19,5	22,0	27,0	EVGE15LN04
L	1/2" NPT	18	160	50,0	19,5	22,0	32,0	EVGE18LN04
L	3/4" NPT	22	160	52,0	19,5	32,0	36,0	EVGE22LN06
L	1" NPT	28	100	60,0	24,5	41,0	41,0	EVGE28LN08
L	1 1/4" NPT	35	100	62,0	25,0	46,0	50,0	EVGE35LN10
L	1 1/2" NPT	42	100	65,5	26,0	50,0	60,0	EVGE42LN12

**Gerade Einschraubverschraubung mit Schaft,
Einschraubgewinde NPT, schwere Reihe**
straight male stud coupling,
union adjustable, male thread NPT, heavy duty series

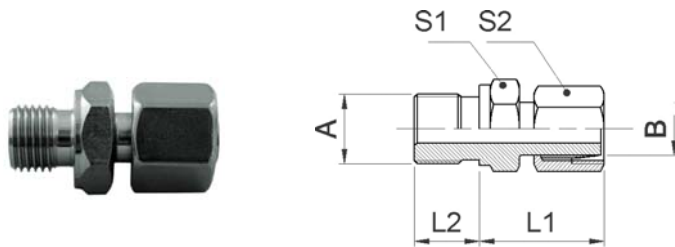

Reihe series	A / Gewinde thread	B / Rohr pipe	PN bar	L1 (mm)	L2 (mm)	S1 (mm)	S2 (mm)	Art. Nr. order no.
S	1/4" NPT	6	630	42,0	14,5	19,0	17,0	EVGE06SN02
S	1/4" NPT	8	630	41,0	14,5	17,0	19,0	EVGE08SN02
S	3/8" NPT	10	630	45,0	14,5	19,0	22,0	EVGE10SN03
S	3/8" NPT	12	630	45,0	14,5	19,0	24,0	EVGE12SN03
S	1/2" NPT	14	630	52,0	19,5	22,0	27,0	EVGE14SN04
S	1/2" NPT	16	400	51,0	19,5	22,0	30,0	EVGE16SN04
S	3/4" NPT	20	400	60,5	19,5	30,0	36,0	EVGE20SN06
S	1" NPT	25	400	70,0	24,5	36,0	46,0	EVGE25SN08
S	1 1/4" NPT	30	250	51,0	25,0	50,0	50,0	EVGE30SN10
S	1 1/2" NPT	38	250	78,0	26,0	50,0	60,0	EVGE38SN12

**Winkel-Einschraubverschraubung mit Schaft,
leichte Reihe**
elbow male stud coupling,
union adjustable, light duty series

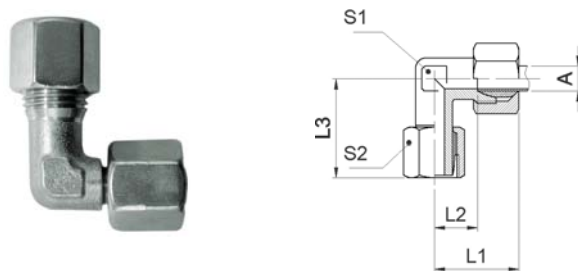

Reihe series	A / Rohr pipe	PN bar	L1 (mm)	L2 (mm)	L3 (mm)	S1 (mm)	S2 (mm)	Art. Nr. order no.
L	6	250	27	12,0	28,0	12,0	14,0	EVW06L
L	8	250	29	14,0	27,5	12,0	17,0	EVW08L
L	10	250	30	15,0	28,0	14,0	19,0	EVW10L
L	12	250	32	17,0	31,5	17,0	22,0	EVW12L
L	15	250	36	21,0	36,0	19,0	27,0	EVW15L
L	18	160	40	23,5	38,0	24,0	32,0	EVW18L
L	22	160	46	27,5	47,0	27,0	36,0	EVW22L
L	28	100	48	30,5	50,5	36,0	41,0	EVW28L
L	35	100	56	34,5	57,0	41,0	50,0	EVW35L
L	42	100	63	40,0	63,5	50,0	60,0	EVW42L

Winkel-Einschraubverschraubung mit Schaft, schwere Reihe
elbow male stud coupling,
union adjustable, heavy duty series

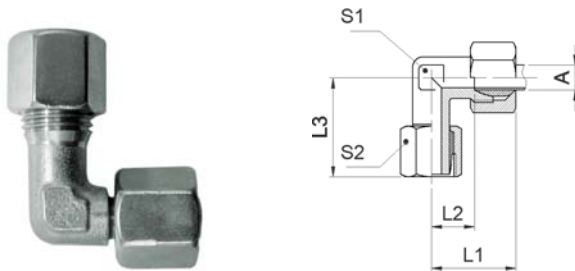

Reihe series	A / Rohr pipe	PN bar	L1 (mm)	L2 (mm)	L3 (mm)	S1 (mm)	S2 (mm)	Art. Nr. order no.
S	6	630	31	16,5	27,0	12,0	17,0	EVW06S
S	8	630	32	17,0	28,5	14,0	19,0	EVW08S
S	10	630	34	17,5	32,0	17,0	22,0	EVW10S
S	12	630	38	21,5	31,5	17,0	24,0	EVW12S
S	14	630	40	22,0	36,0	19,0	27,0	EVW14S
S	16	400	43	24,5	37,5	24,0	30,0	EVW16S
S	20	400	48	26,5	46,0	27,0	36,0	EVW20S
S	25	400	54	30,0	50,5	36,0	46,0	EVW25S
S	30	250	62	35,5	56,5	41,0	50,0	EVW30S
S	38	250	72	41,0	64,0	50,0	60,0	EVW38S

T-Einschraubverschraubung mit Schaft, leichte Reihe
T- male stud coupling,
union adjustable, light duty series

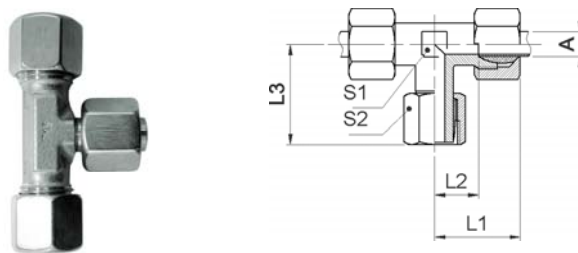

Reihe series	A / Rohr pipe	PN bar	L1 (mm)	L2 (mm)	L3 (mm)	S1 (mm)	S2 (mm)	Art. Nr. order no.
L	6	250	27	12,0	26,0	12,0	14,0	EVT06L
L	8	250	29	14,0	28,0	12,0	17,0	EVT08L
L	10	250	30	15,0	29,0	14,0	19,0	EVT10L
L	12	250	32	17,0	32,0	17,0	22,0	EVT12L
L	15	250	36	21,0	35,0	19,0	27,0	EVT15L
L	18	160	40	23,5	37,5	24,0	32,0	EVT18L
L	22	160	44	27,5	43,0	27,0	36,0	EVT22L
L	28	100	47	30,5	43,5	36,0	41,0	EVT28L
L	35	100	56	34,5	56,5	41,0	50,0	EVT35L
L	42	100	63	40,0	59,0	50,0	60,0	EVT42L

T-Einschraubverschraubung mit Schaft, schwere Reihe

T- male stud coupling, union adjustable, heavy duty series

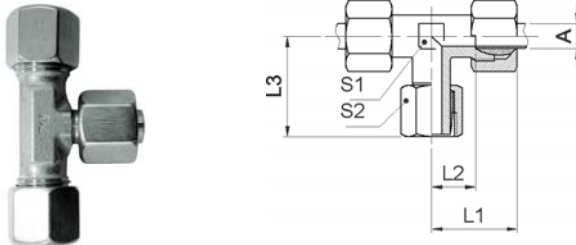

Reihe series	A / Rohr pipe	PN bar	L1 (mm)	L2 (mm)	L3 (mm)	S1 (mm)	S2 (mm)	Art. Nr. order no.
S	6	630	31	16,0	27,0	12,0	17,0	EVT06S
S	8	630	32	17,0	28,0	14,0	19,0	EVT08S
S	10	630	34	17,5	30,0	17,0	22,0	EVT10S
S	12	630	38	21,5	33,0	17,0	24,0	EVT12S
S	14	630	40	22,0	36,0	19,0	27,0	EVT14S
S	16	400	43	24,5	37,5	24,0	30,0	EVT16S
S	20	400	48	26,5	47,0	27,0	36,0	EVT20S
S	25	400	54	30,0	50,5	36,0	46,0	EVT25S
S	30	250	62	36,0	58,0	41,0	50,0	EVT30S
S	38	250	72	41,0	62,0	50,0	60,0	EVT38S

L-Einschraubverschraubung mit Schaft, leichte Reihe

L- male stud coupling, union adjustable, light duty series

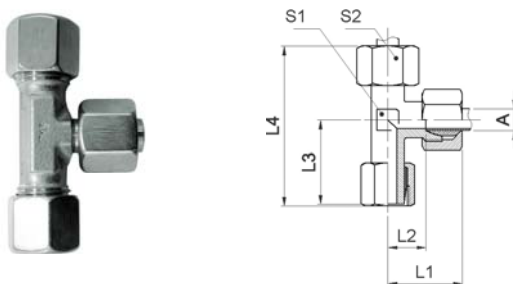

Reihe series	A / Rohr pipe	B / Gewinde thread	PN bar	L1 (mm)	L2 (mm)	L3 (mm)	L4 (mm)	S1 (mm)	S2 (mm)	Art. Nr. order no.
L	6	M12x1,5	250	27,0	13,0	28,0	56,0	12,0	14,0	EVL06L
L	8	M14x1,5	250	29,0	14,0	27,5	56,0	12,0	17,0	EVL08L
L	10	M16x1,5	250	31,0	15,0	28,0	59,0	14,0	19,0	EVL10L
L	12	M18x1,5	250	32,0	17,5	30,5	62,0	17,0	22,0	EVL12L
L	15	M22x1,5	250	36,0	21,0	35,5	72,0	19,0	27,0	EVL15L
L	18	M26x1,5	160	40,0	23,5	37,0	76,0	24,0	32,0	EVL18L
L	22	M30x2,0	160	44,0	27,5	45,0	91,0	27,0	36,0	EVL22L
L	28	M36x2,0	100	47,0	31,0	48,5	96,0	36,0	41,0	EVL28L
L	35	M45x2,0	100	56,0	34,5	54,5	111,0	41,0	50,0	EVL35L
L	42	M52x2,0	100	63,0	40,0	62,0	126,0	50,0	60,0	EVL42L

L-Einschraubverschraubung mit Schaft, schwere Reihe

L- male stud coupling, union adjustable, heavy duty series

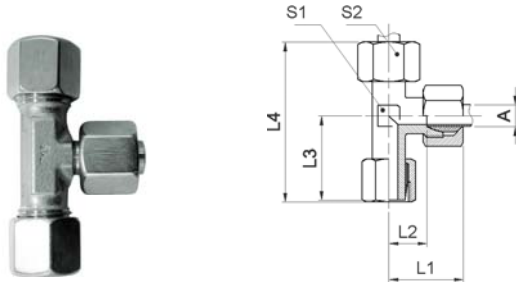

Reihe series	A / Gewinde thread	B / Gewinde thread	PN bar	L1 (mm)	L2 (mm)	L2 (mm)	L2 (mm)	S1 (mm)	S2 (mm)	Art. Nr. order no.
S	6	M14x1,5	630	31,0	16,5	27,0	58,0	12,0	17,0	EVL06S
S	8	M16x1,5	630	32,0	17,0	29,0	61,0	14,0	19,0	EVL08S
S	10	M18x1,5	630	34,0	17,5	30,0	66,0	17,0	22,0	EVL10S
S	12	M20x1,5	630	38,0	22,0	32,0	70,0	17,0	24,0	EVL12S
S	14	M22x1,5	630	40,0	22,0	35,0	76,0	19,0	27,0	EVL14S
S	16	M24x1,5	400	43,0	24,5	37,5	80,0	24,0	30,0	EVL16S
S	20	M30x2,0	400	48,0	26,5	44,5	93,0	27,0	36,0	EVL20S
S	25	M36x2,0	400	54,0	30,0	49,0	105,0	36,0	46,0	EVL25S
S	30	M45x2,0	250	62,0	34,5	56,5	119,0	41,0	50,0	EVL30S
S	38	M52x2,0	250	72,0	42,0	62,5	137,0	50,0	60,0	EVL38S

Reduzierschraubungen mit Schaft
Reducing couplings with union adjustable

Manometer-Aufschraubverschraubung mit Schaft, Aufschraubgewinde BSPP, leichte Reihe
manometer female coupling, union adjustable, female thread BSPP light duty series

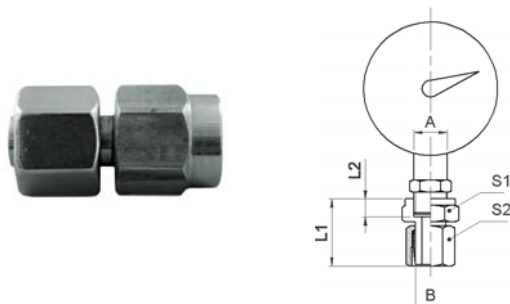

Reihe series	A / Rohr pipe	B / Gewinde thread	PN bar	L1 (mm)	L2 (mm)	S1 (mm)	S2 (mm)	Art. Nr. order no.
L	6	G 1/4"	250	38,0	14,5	19,0	14,0	MAVEV06L02
L	8	G 1/4"	250	40,0	14,5	19,0	17,0	MAVEV08L02
L	10	G 1/4"	250	39,5	14,5	19,0	19,0	MAVEV10L02
L	10	G 1/2"	250	48,0	20,0	27,0	19,0	MAVEV10L04
L	12	G 1/4"	250	40,5	14,5	19,0	22,0	MAVEV12L02
L	12	G 1/2"	250	48,0	20,0	27,0	22,0	MAVEV12L04

Reduzierschraubungen mit Schaft Reducing couplings with union adjustable

Manometer-Aufschraubverschraubung mit Schaft, Aufschraubgewinde BSPP, leichte + schwere Reihe
manometer female coupling, union adjustable, female thread BSPP, light + heavy duty series

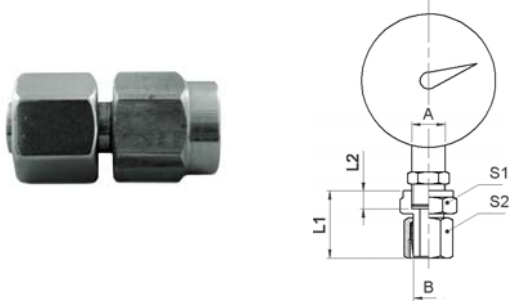

Reihe series	A / Gewinde thread	B / Gewinde thread	PN bar	L1 (mm)	L2 (mm)	S1 (mm)	S2 (mm)	Art. Nr. order no.
S	6	G 1/2"	630	45,0	20,0	27,0	17,0	MAVEV06S04
S	8	G 1/2"	630	45,0	20,0	27,0	19,0	MAVEV08S04
S	10	G 1/2"	630	47,5	20,0	27,0	22,0	MAVEV10S04
S	12	G 1/2"	630	48,0	20,0	27,0	24,0	MAVEV12S04

Gerade Reduzierung mit Schaft, leichte Reihe
straight reducing coupling, union adjustable, light duty series

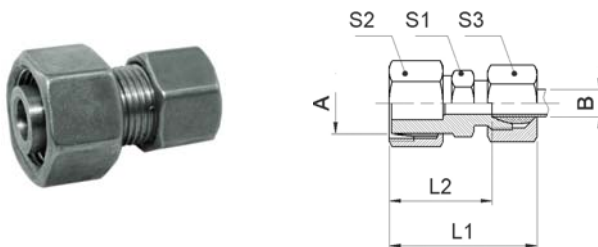

Reihe series	A / Gewinde thread	B / Rohr pipe	PN bar	L1 (mm)	L2 (mm)	S1 (mm)	S2 (mm)	S3 (mm)	Art. Nr. order no.
L	8	6	250	40,0	25,5	14,0	17,0	14,0	KOR0806L
L	10	6	250	40,0	26,5	12,0	19,0	14,0	KOR1006L
L	10	8	250	41,0	27,0	14,0	19,0	17,0	KOR1008L
L	12	6	250	41,0	27,0	14,0	22,0	14,0	KOR1206L
L	12	8	250	42,0	28,0	14,0	22,0	17,0	KOR1208L
L	12	10	250	43,0	28,5	17,0	22,0	19,0	KOR1210L
L	15	6	250	46,0	31,5	14,0	27,0	14,0	KOR1506L
L	15	8	250	47,0	31,5	17,0	27,0	17,0	KOR1508L
L	15	10	250	47,0	31,5	17,0	27,0	19,0	KOR1510L
L	15	12	250	47,0	32,0	19,0	27,0	22,0	KOR1512L
L	18	6	160	45,0	30,0	19,0	32,0	14,0	KOR1806L
L	18	8	160	45,0	30,0	19,0	32,0	17,0	KOR1808L
L	18	10	160	48,0	32,5	19,0	32,0	19,0	KOR1810L
L	18	12	160	48,0	33,0	19,0	32,0	22,0	KOR1812L

Gerade Reduzierung mit Schaft,
leichte + schwere Reihe
straight reducing coupling,
union adjustable, light + heavy duty series

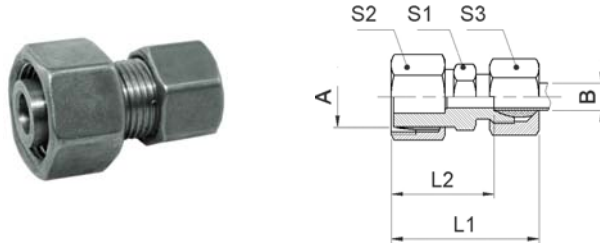

Reihe series	A / Gewinde thread	B / Rohr pipe	PN bar	L1 (mm)	L2 (mm)	S1 (mm)	S2 (mm)	S3 (mm)	Art. Nr. order no.
L	18	15	160	50,0	34,0	24,0	32,0	27,0	KOR1815L
L	22	6	160	50,0	33,0	24,0	36,0	14,0	KOR2206L
L	22	8	160	50,0	33,0	24,0	36,0	17,0	KOR2208L
L	22	10	160	50,0	34,0	24,0	36,0	19,0	KOR2210L
L	22	12	160	51,0	35,0	24,0	36,0	22,0	KOR2212L
L	22	15	160	52,0	36,0	24,0	36,0	27,0	KOR2215L
L	22	18	160	53,0	36,5	27,0	36,0	32,0	KOR2218L
L	28	10	100	51,0	34,5	30,0	41,0	19,0	KOR2810L
L	28	12	100	52,0	36,0	30,0	41,0	22,0	KOR2812L
L	28	15	100	54,0	38,0	30,0	41,0	27,0	KOR2815L
L	28	18	100	54,0	38,0	30,0	41,0	32,0	KOR2818L
L	28	22	100	56,0	40,0	32,0	41,0	36,0	KOR2822L
L	35	22	100	63,0	44,5	36,0	50,0	36,0	KOR3522L
L	35	28	100	64,0	46,5	41,0	50,0	41,0	KOR3528L
L	42	22	100	65,0	47,5	46,0	60,0	36,0	KOR4222L
L	42	28	100	65,0	47,5	46,0	60,0	41,0	KOR4228L
L	42	35	100	68,0	46,0	46,0	60,0	50,0	KOR4235L

Reihe series	A / Gewinde thread	B / Rohr pipe	PN bar	L1 (mm)	L2 (mm)	S1 (mm)	S2 (mm)	S3 (mm)	Art. Nr. order no.
S	8	6	630	45,0	30,0	19,0	17,0	14,0	KOR0806S
S	10	6	630	47,0	32,0	22,0	17,0	14,0	KOR1006S
S	10	8	630	49,5	34,0	22,0	19,0	17,0	KOR1008S
S	12	6	630	49,0	32,0	24,0	17,0	14,0	KOR1206S
S	12	8	630	49,0	34,0	24,0	19,0	17,0	KOR1208S
S	12	10	630	50,0	33,5	24,0	22,0	19,0	KOR1210S
S	14	6	630	48,0	34,0	27,0	17,0	17,0	KOR1406S
S	14	8	630	52,0	37,0	27,0	19,0	17,0	KOR1408S
S	14	10	630	53,0	36,0	27,0	22,0	19,0	KOR1410S
S	14	12	630	55,0	38,5	27,0	24,0	22,0	KOR1412S
S	14	16	400	59,0	40,0	27,0	30,0	27,0	KOR1416S
S	16	6	400	50,0	35,0	30,0	17,0	17,0	KOR1606S
S	16	8	400	52,0	37,0	30,0	19,0	17,0	KOR1608S
S	16	10	400	53,0	37,0	30,0	22,0	19,0	KOR1610S
S	16	12	400	53,0	33,5	30,0	24,0	22,0	KOR1612S
S	16	14	400	57,0	35,0	30,0	27,0	24,0	KOR1614S
S	16	25	400	70,0	42,0	30,0	46,0	41,0	KOR1625S
S	20	6	400	57,0	41,0	36,0	17,0	22,0	KOR2006S
S	20	8	400	58,0	42,5	36,0	19,0	22,0	KOR2008S
S	20	10	400	58,0	40,5	36,0	22,0	22,0	KOR2010S

**Gerade Reduzierung mit Schaft,
schwere Reihe**
straight reducing coupling,
union adjustable, heavy duty series

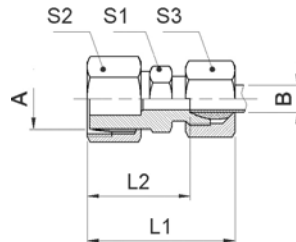

Reihe series	A / Gewinde thread	B / Rohr pipe	PN bar	L1 (mm)	L2 (mm)	S1 (mm)	S2 (mm)	S3 (mm)	Art. Nr. order no.
S	20	12	400	59,0	42,0	36,0	24,0	22,0	KOR2012S
S	20	14	400	63,0	45,0	36,0	27,0	24,0	KOR2014S
S	20	16	400	63,0	44,5	36,0	30,0	27,0	KOR2016S
S	25	6	400	53,0	38,0	46,0	17,0	27,0	KOR2506S
S	25	8	400	53,0	38,0	46,0	19,0	27,0	KOR2508S
S	25	10	400	60,0	46,5	46,0	22,0	27,0	KOR2510S
S	25	12	400	64,0	47,0	46,0	24,0	27,0	KOR2512S
S	25	14	400	66,0	47,0	46,0	27,0	27,0	KOR2514S
S	25	16	400	65,0	46,5	46,0	30,0	27,0	KOR2516S
S	25	20	400	70,0	48,5	46,0	36,0	32,0	KOR2520S
S	30	8	250	55,0	39,5	50,0	19,0	32,0	KOR3008S
S	30	10	250	57,0	39,5	50,0	22,0	32,0	KOR3010S
S	30	12	250	68,0	51,0	50,0	24,0	32,0	KOR3012S
S	30	14	250	70,0	53,0	50,0	27,0	32,0	KOR3014S
S	30	16	250	72,0	52,5	50,0	30,0	32,0	KOR3016S
S	30	20	250	75,0	52,5	50,0	36,0	32,0	KOR3020S
S	30	25	250	81,0	56,5	50,0	46,0	41,0	KOR3025S
S	38	12	250	72,0	55,0	60,0	24,0	41,0	KOR3812S
S	38	14	250	76,0	56,5	60,0	27,0	41,0	KOR3814S

Zubehör für Verschraubungen
Accessories for couplings

Überwurfmuttern für Schneidringe,
leichte + schwere Reihe
union nut for coupling,
light + heavy duty series

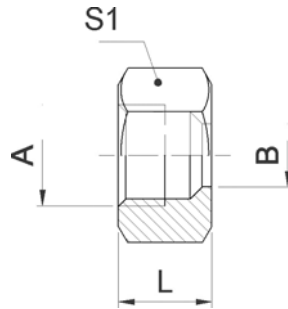

Reihe series	A / Gewinde thread	B / Rohr pipe	PN bar	L (mm)	S1 (mm)	Art. Nr. order no.
L	M12x1,5	6	250	15,3	14,0	M06L
L	M14x1,5	8	250	15,3	17,0	M08L
L	M16x1,5	10	250	16,0	19,0	M10L
L	M18x1,5	12	250	16,0	22,0	M12L
L	M22x1,5	15	250	17,5	27,0	M15L
L	M26x1,5	18	160	18,5	32,0	M18L
L	M30x2,0	22	160	20,0	36,0	M22L
L	M36x2,0	28	100	21,0	41,0	M28L
L	M45x2,0	35	100	24,0	50,0	M35L
L	M52x2,0	42	100	24,0	60,0	M42L

Reihe series	A / Gewinde thread	B / Rohr pipe	PN bar	L (mm)	S1 (mm)	Art. Nr. order no.
S	M14x1,5	6	630	16,5	17,0	M06S
S	M16x1,5	8	630	16,5	19,0	M08S
S	M18x1,5	10	630	18,0	22,0	M10S
S	M20x1,5	12	630	18,5	24,0	M12S
S	M22x1,5	14	630	21,0	27,0	M14S
S	M24x1,5	16	400	20,5	30,0	M16S
S	M30x2,0	20	400	24,5	36,0	M20S
S	M36x2,0	25	400	27,0	46,0	M25S
S	M42x2,0	30	250	29,0	50,0	M30S
S	M52x2,0	38	250	32,5	60,0	M38S

**2-Kanten Schneidring,
leichte + schwere Reihe**
double cutting ring,
light and heavy duty series

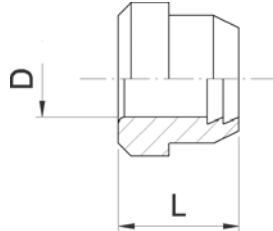

Reihe series	D / Rohr pipe	PN bar	L (mm)	Art. Nr. order no.
L/S	6	250/630	9,5	D06L/S
L/S	8	250/630	9,0	D08L/S
L/S	10	250/630	9,5	D10L/S
L/S	12	250/630	10,0	D12L/S

Reihe series	D / Rohr pipe	PN bar	L (mm)	Art. Nr. order no.
L	15	250	10,2	D15L
L	18	160	10,2	D18L
L	22	160	11,5	D22L
L	28	100	11,0	D28L
L	35	100	13,5	D35L
L	42	100	13,5	D42L

Reihe series	D / Rohr pipe	PN bar	L (mm)	Art. Nr. order no.
S	14	630	10,5	D14S
S	16	400	10,5	D16S
S	20	400	12,7	D20S
S	25	400	13,5	D25S
S	30	250	13,0	D30S
S	38	250	13,5	D38S
S	14	630	10,5	D14S
S	16	400	10,5	D16S
S	20	400	12,7	D20S
S	25	400	13,5	D25S
S	30	250	13,0	D30S
S	38	250	13,5	D38S

Verschlusskegel für 24° Konus,
leichte + schwere Reihe
blanking plug for 24° cone,
light and heavy duty series

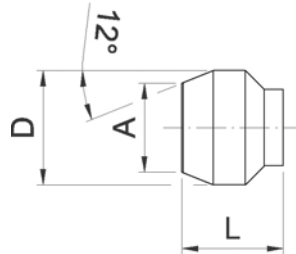

Reihe series	A / Rohr pipe	L (mm)	D (mm)	Art. Nr. order no.
L	6	17,0	9,0	BUZ06
L	8	17,0	11,0	BUZ08
L	10	17,0	13,0	BUZ10
L	12	18,0	15,0	BUZ12
L	15	20,0	18,0	BUZ15
L	18	20,0	22,0	BUZ18
L	22	22,0	26,0	BUZ22
L	28	25,0	32,0	BUZ28
L	35	30,5	40,0	BUZ35
L	42	31	48	BUZ42

Reihe series	A / Rohr pipe	L (mm)	D (mm)	Art. Nr. order no.
S	6	17,0	9,0	BUZ06
S	8	17,0	11,0	BUZ08
S	10	17,0	13,0	BUZ10
S	12	18,0	15,0	BUZ12
S	14	20,0	17,0	BUZ14
S	16	20,0	19,0	BUZ16
S	20	24,0	25,0	BUZ20
S	25	27,0	30,0	BUZ25
S	30	28,0	36,0	BUZ30
S	38	31,0	45,0	BUZ38

Verschlusskegel für 24° Konus mit O-Ring,
leichte + schwere Reihe
blanking plug for 24° cone with o-ring,
light and heavy duty series

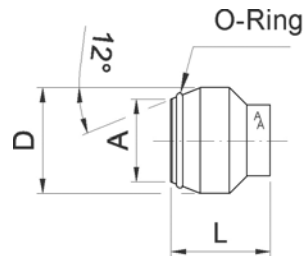

Reihe series	A / Rohr pipe	L (mm)	D (mm)	Art. Nr. order no.
L	6	17,0	9,0	BUZ06ED
L	8	17,0	11,0	BUZ08ED
L	10	17,0	13,0	BUZ10ED
L	12	18,0	15,0	BUZ12ED
L	15	20,0	18,0	BUZ15ED
L	18	20,0	22,0	BUZ18ED
L	22	22,0	26,0	BUZ22ED
L	28	25,0	32,0	BUZ28ED
L	35	30,5	40,0	BUZ35ED
L	42	31,0	48,0	BUZ42ED

Reihe series	A / Rohr pipe	L (mm)	D (mm)	Art. Nr. order no.
S	6	17,0	9,0	BUZ06ED
S	8	17,0	11,0	BUZ08ED
S	10	17,0	13,0	BUZ10ED
S	12	18,0	15,0	BUZ12ED
S	14	20,0	17,0	BUZ14ED
S	16	20,0	19,0	BUZ16ED
S	20	24,0	25,0	BUZ20ED
S	25	27,0	30,0	BUZ25ED
S	30	28,0	36,0	BUZ30ED
S	38	31,0	45,0	BUZ38ED

Gewindereduzierungen Thread reducers

**Gewindereduzierung,
Einschraubgewinde BSPP mit Dichtkante Form B, Aufschraubgewinde BSPP**
thread reducer,
male thread BSPP with sealing edge form B, female thread BSPP

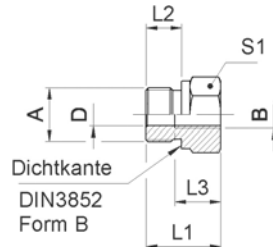

A / Gewinde thread	B / Gewinde thread	L1 (mm)	L2 (mm)	L3 (mm)	S1 (mm)	D (mm)	Art. Nr. order no.
G 1/8"	G 1/4"	31,0	8,0	17,0	19,0	4,0	RI0102
G 1/8"	G 3/8"	32,0	8,0	17,0	24,0	4,0	RI0103
G 1/8"	G 1/2"	36,0	8,0	20,0	27,0	4,0	RI0104
G 1/4"	G 1/8"	28,0	12,0	12,0	19,0	5,0	RI0201
G 1/4"	G 3/8"	36,0	12,0	17,0	24,0	5,0	RI0203
G 1/4"	G 1/2"	40,0	12,0	20,0	27,0	5,0	RI0204
G 1/4"	G 3/4"	43,0	12,0	22,0	36,0	5,0	RI0206
G 3/8"	G 1/8"	23,0	12,0	12,0	22,0	8,5	RI0301
G 3/8"	G 1/4"	36,0	12,0	17,0	22,0	8,0	RI0302
G 3/8"	G 1/2"	41,0	12,0	20,0	27,0	8,0	RI0304
G 3/8"	G 3/4"	44,0	12,0	22,0	36,0	8,0	RI0306
G 3/8"	G 1"	47,0	12,0	24,0	41,0	8,0	RI0308
G 1/2"	G 1/8"	24,0	14,0	12,0	27,0	8,5	RI0401
G 1/2"	G 1/4"	24,0	14,0	14,0	27,0	11,5	RI0402
G 1/2"	G 3/8"	36,0	14,0	17,0	27,0	12,0	RI0403
G 1/2"	G 1/2"	45,0	14,0	20,0	27,0	12,0	RI0404
G 1/2"	G 3/4"	47,0	14,0	22,0	36,0	12,0	RI0406
G 1/2"	G 1"	49,0	14,0	25,0	41,0	12,0	RI0408
G 1/2"	G 1 1/4"	53,0	14,0	27,0	55,0	10,0	RI0410
G 1/2"	G 1 1/2"	55,0	15,0	29,0	60,0	10,0	RI0412
G 3/4"	G 1/4"	26,0	16,0	18,0	32,0	11,5	RI0602
G 3/4"	G 3/8"	26,0	16,0	16,0	32,0	15,0	RI0603
G 3/4"	G 1/2"	41,0	16,0	20,0	32,0	16,0	RI0604
G 3/4"	G 1"	51,0	16,0	24,5	41,0	16,0	RI0608
G 3/4"	G 1 1/4"	55,0	16,0	26,0	55,0	16,5	RI0610
G 3/4"	G 1 1/2"	57,0	16,0	29,0	60,0	16,0	RI0612
G 1"	G 3/8"	29,0	18,0	17,0	41,0	15,0	RI0803
G 1"	G 1/2"	29,0	18,0	18,0	41,0	18,5	RI0804
G 1"	G 3/4"	47,0	18,0	22,0	41,0	20,0	RI0806
G 1"	G 1"	52,0	18,0	24,5	41,0	20,0	RI0808
G 1"	G 1 1/4"	57,0	18,0	26,5	55,0	20,0	RI0810
G 1"	G 1 1/2"	59,0	18,0	28,0	60,0	20,0	RI0812
G 1 1/4"	G 1/2"	32,0	20,0	20,0	50,0	18,5	RI1004
G 1 1/4"	G 3/4"	32,0	20,0	18,5	50,0	24,5	RI1006
G 1 1/4"	G 1"	52,0	20,0	24,5	50,0	24,5	RI1008
G 1 1/4"	G 1 1/2"	60,0	20,0	28,5	60,0	25,0	RI1012

**Gewindereduzierung,
Einschraubgewinde BSPP mit Dichtkante Form B, Aufschraubgewinde BSPP**
thread reducer,
male thread BSPP with sealing edge form B, female thread BSPP

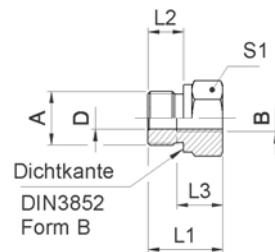

A / Gewinde thread	B / Gewinde thread	L1 (mm)	L2 (mm)	L3 (mm)	S1 (mm)	D (mm)	Art. Nr. order no.
G 1 1/2"	G 1/2"	36,0	22,0	25,0	55,0	19,0	RI1204
G 1 1/2"	G 3/4"	36,0	22,0	23,5	55,0	24,0	RI1206
G 1 1/2"	G 1"	36,0	22,0	23,5	55,0	31,0	RI1208
G 1 1/2"	G 1 1/4"	58,0	22,0	27,0	55,0	32,0	RI1210
G 2"	G 1 1/4"	38,0	24,0	27,0	70,0	32,0	RI1610
G 2"	G 1 1/2"	62,0	24,0	29,0	70,0	40,0	RI1612